



★ PME20-XL-N

Flanged housing unit

Schaeffler ID:
0096434510000

Housing units PME, four-bolt flanged housing units, cast iron, centring spigot, eccentric locking collar, P seals

★ Preferred product

X-life

Technical information

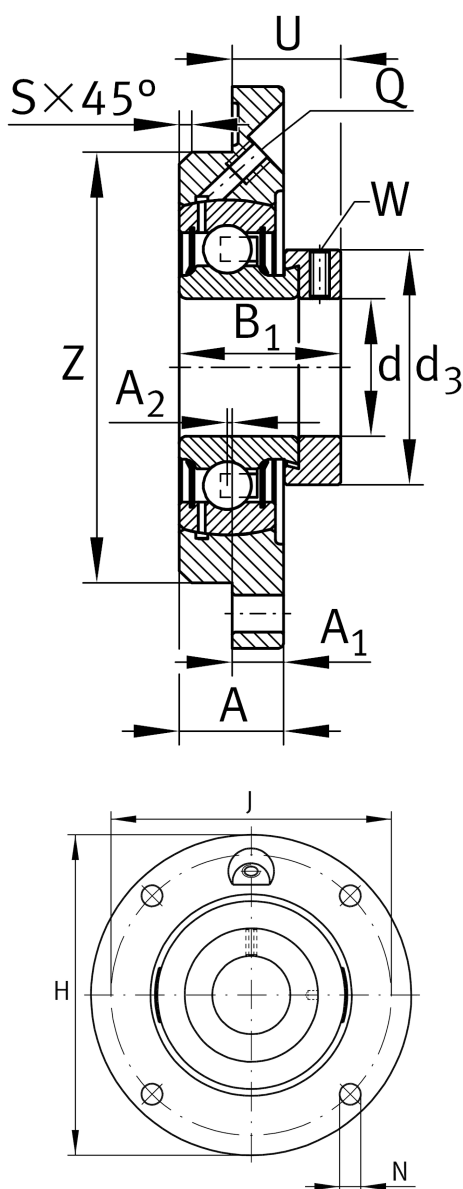

Main Dimensions & Performance Data

d	20 mm	Bore diameter
H	100 mm	Height flange
B ₁	31 mm	Locking collar total width
U	21,5 mm	Total height unit
C _r	13.600 N	Basic dynamic load rating, radial
C _{0r}	6.600 N	Basic static load rating, radial
C _{ur}	345 N	Fatigue load limit, radial
	0,53 kg	Weight

Dimensions

A	17 mm	Height housing
A ₁	8 mm	Thickness of flange
A ₂	2 mm	Distance raceway
S	2 mm	Chamfer width
Q	M6	Connection thread lubrication

Mounting dimensions

J	78 mm	Pitch circle diameter (holes)
N	9 mm	Fixing bore
T ₁	9 mm	Height spigot
Z	62 mm	Diameter spigot
	h8	Diameter spigot clearance
n	4	Number of screwing holes

Additional information

1	Number of housings
ME04	Housing
GRAE20-XL-NPP-B	Bearing designation
KASK04	Protecting cap