

★ 81102-TV

Axial cylindrical roller bearing

Schaeffler ID:
0002402490000

Axial cylindrical roller bearings 811, single direction, comprising K811, GS, WS

★ Preferred product

Technical information

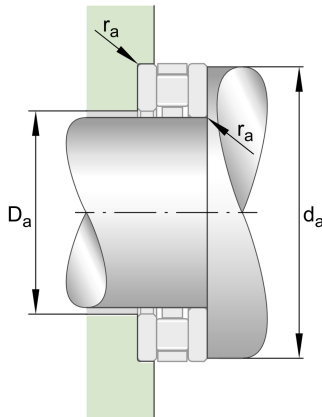
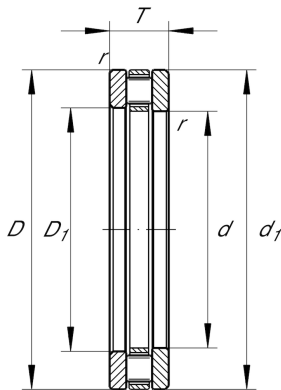

Temperature range

T_{min}	120 °C	Operating temperature min.
T_{max}	-30 °C	Operating temperature max.
	21,3 g	Weight

Main Dimensions & Performance Data

d	15 mm	Bore diameter
D	28 mm	Outside diameter
T	9 mm	Height
C_a	14.400 N	Basic dynamic load rating, axial
C_{0a}	28.500 N	Basic static load rating, axial
C_{ua}	4.050 N	Fatigue load limit, axial
n_G	13.400 1/min	Limiting speed
n_{gr}	6.300 1/min	Reference speed

Dimensions

D_1	16 mm	Bore diameter housing washer
d_1	28 mm	Rip diameter shaft washer
r_{min}	0,3 mm	Minimum chamfer dimension

Mounting dimensions

$d_{a min}$	27 mm	Minimum diameter shaft shoulder
$D_{a max}$	16 mm	Maximum diameter of housing shoulder
$r_{a max}$	0,3 mm	Maximum recess radius

Additional information

K81102-TV	Axial roller and cage assembly
GS81102	Housing Washer
WS81102	Shaft washer
LS1528	Track Washer