

★ 81111-TV

Axial cylindrical roller bearing

Schaeffler ID:
0007105470000

Axial cylindrical roller bearings 811, single direction, comprising K811, GS, WS

★ Preferred product

Technical information

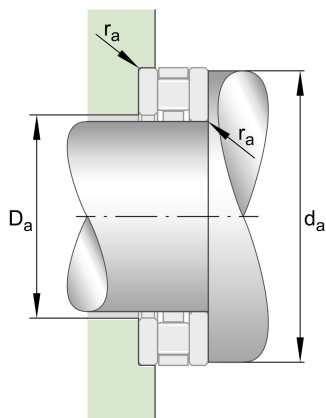
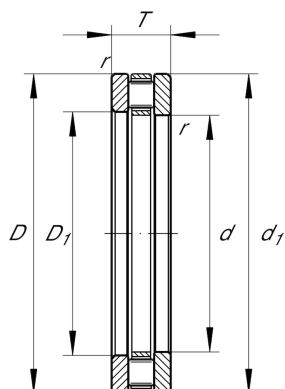

Temperature range

T_{\min}	120 °C	Operating temperature min.
T_{\max}	-30 °C	Operating temperature max.
	0,002 kg	Weight

Main Dimensions & Performance Data

d	55 mm	Bore diameter
D	78 mm	Outside diameter
T	16 mm	Height
C_a	90.000 N	Basic dynamic load rating, axial
C_{0a}	300.000 N	Basic static load rating, axial
C_{ua}	31.500 N	Fatigue load limit, axial
n_G	4.350 1/min	Limiting speed
n_{gr}	1.350 1/min	Reference speed

Dimensions

D_1	57 mm	Bore diameter housing washer
d_1	78 mm	Rip diameter shaft washer
r_{\min}	0,6 mm	Minimum chamfer dimension

Mounting dimensions

$d_{a \min}$	77 mm	Minimum diameter shaft shoulder
$D_{a \max}$	56 mm	Maximum diameter of housing shoulder
$r_{a \max}$	0,6 mm	Maximum recess radius

Additional information

K81111-TV	Axial roller and cage assembly
GS81111	Housing Washer
WS81111	Shaft washer
LS5578	Track Washer