

★ E60-XL-KRR

Radial insert ball bearing

Schaeffler ID:
0008036930000

★ Preferred product

Radial insert ball bearings E..-KRR, cylindrical outer ring, location by eccentric locking collar, R seals on both sides

X-life

Technical information

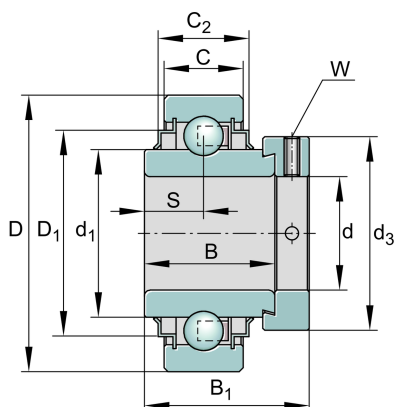

Main Dimensions & Performance Data

d	60 mm	Bore diameter
D	110 mm	Outside diameter
B	61,9 mm	Width
B ₁	77,9 mm	Locking collar total width
C _r	56.000 N	Basic dynamic load rating, radial
C _{0r}	36.000 N	Basic static load rating, radial
C _{ur}	1.870 N	Fatigue load limit, radial
	1,82 kg	Weight

Dimensions

C	24 mm	Width, outer ring
C ₂	29 mm	Sealing total width
S	31 mm	Distance raceway
d ₁	76,5 mm	Rib diameter inner ring
D ₁	94,5 mm	Outside diameter seal
d ₃	84 mm	Outside diameter locking collar/locknut
W	5 mm	Width of flats

Calculation factors

f ₀	14,3	Calculation factor
----------------	------	--------------------