

★ GRAE60-XL-NPP-B

Radial insert ball bearing

Schaeffler ID:
0008495610000

Radial insert ball bearing GRAE...XL-NPP-B

★ Preferred product

X-life

Technical information

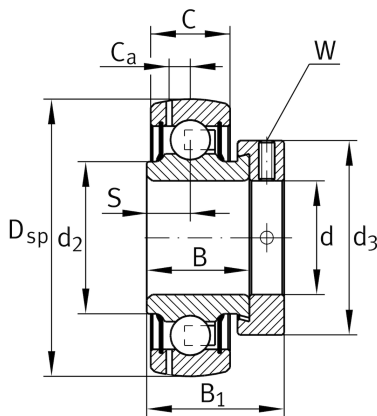

Main Dimensions & Performance Data

d	60 mm	Bore diameter
D _{SP}	110 mm	Outside diameter
B	37,1 mm	Width
B ₁	53,1 mm	Locking collar total width
n _{G Grease}	7.300 1/min	Limiting speed for grease lubrication
C _r	56.000 N	Basic dynamic load rating, radial
C _{0r}	36.000 N	Basic static load rating, radial
C _{ur}	1.870 N	Fatigue load limit, radial
	1,4 kg	Weight

Dimensions

C	24 mm	Width, outer ring
S	13,5 mm	Distance raceway
d ₂	72 mm	Rib diameter sealing inner ring
C _a	7,2 mm	Distance to lubrication hole
d ₃	84 mm	Outside diameter locking collar/locknut
W	5 mm	Width of flats

Additional information

f ₀	14,3	Calculation factor
----------------	------	--------------------