

★ GNE40-XL-KRR-B

Radial insert ball bearing

Schaeffler ID:
0009443510000

★ Preferred product

Radial insert ball bearings GNE...KRR-B, spherical outer ring, location by eccentric locking collar, R seals on both sides

X-life

Technical information

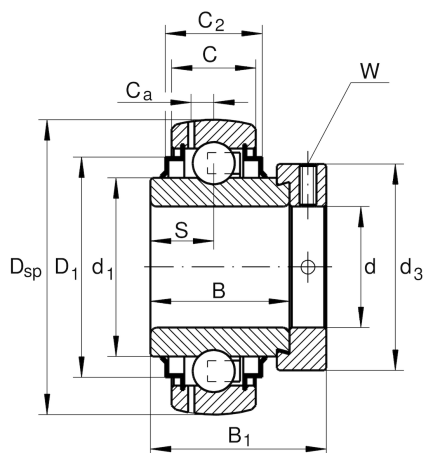

Main Dimensions & Performance Data

| | | |
|-----------------------|-------------|---------------------------------------|
| d | 40 mm | Bore diameter |
| D _{SP} | 90 mm | Outside diameter |
| B | 41 mm | Width |
| B ₁ | 54,6 mm | Locking collar total width |
| n _{G Grease} | 9.100 1/min | Limiting speed for grease lubrication |
| C _r | 47.000 N | Basic dynamic load rating, radial |
| C _{0r} | 26.000 N | Basic static load rating, radial |
| C _{ur} | 1.360 N | Fatigue load limit, radial |
| | 1,02 kg | Weight |

Dimensions

| | | |
|----------------|---------|---|
| C | 23 mm | Width, outer ring |
| C ₂ | 26 mm | Sealing total width |
| S | 18 mm | Distance raceway |
| d ₁ | 53,8 mm | Rib diameter inner ring |
| D ₁ | 74,5 mm | Outside diameter seal |
| C _a | 7,5 mm | Distance to lubrication hole |
| d ₃ | 63 mm | Outside diameter locking collar/locknut |
| W | 5 mm | Width of flats |

Additional information

| | | |
|----------------|------|--------------------|
| f ₀ | 12,9 | Calculation factor |
|----------------|------|--------------------|