

★ PE20-XL

Deep groove ball bearing

Schaeffler ID:
0009493880000

★ Preferred product

Radial insert ball bearings PE, cylindrical outer ring, with steel aligning ring, location by eccentric locking collar, P seals on both sides

X-life

Technical information

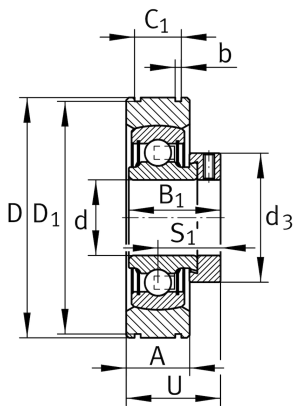

Main Dimensions & Performance Data

d	20 mm	Bore diameter
D	55 mm	Outside diameter
U	31,5 mm	Width
C_r	13.600 N	Basic dynamic load rating, radial
C_{0r}	6.600 N	Basic static load rating, radial
C_{ur}	345 N	Fatigue load limit, radial
	0,25 kg	Weight

Dimensions

A	16 mm	Width, outer ring
C_1	11,2 mm	Distance ring grooves
	0,2 mm	Upper distance ring groove tolerance
b	1,35 mm	Width retaining slot
	0,3 mm	Nut width upper tolerance
D_1	52,6 mm	Diameter of groove
	-0,5 mm	Nut diameter lower tolerance

Calculation factors

	RAE20-XL-NPP-B	Bearing designation
f_0	13,1	Calculation factor