



★ GYE16-XL-KRR-B

Radial insert ball bearing

Schaeffler ID:
0009706110000

★ Preferred product

Radial insert ball bearings GYE..-KRR-B, spherical outer ring, location by grub screws, R seals on both sides

X-life

Technical information

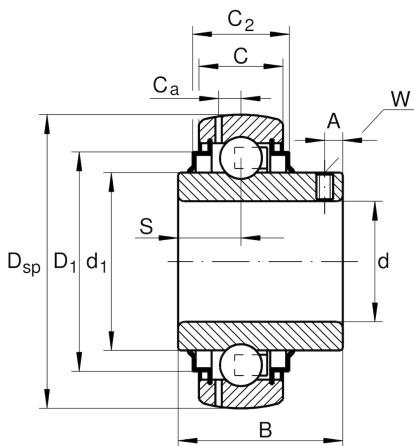

Main Dimensions & Performance Data

d	16 mm	Bore diameter
D _{SP}	40 mm	Outside diameter
B	27,4 mm	Width
n _{G Grease}	22.300 1/min	Limiting speed for grease lubrication
C _r	9.800 N	Basic dynamic load rating, radial
C _{0r}	4.750 N	Basic static load rating, radial
C _{ur}	202 N	Fatigue load limit, radial
	0,094 kg	Weight

Dimensions

C	12 mm	Width, outer ring
C ₂	16,6 mm	Sealing total width
S	11,5 mm	Distance raceway
d ₁	23,9 mm	Rib diameter inner ring
D ₁	31,6 mm	Outside diameter seal
C _a	3,4 mm	Distance to lubrication hole
A	4 mm	Distance thread
W	2.5 mm	Width of flats

Additional information

f ₀	13	Calculation factor
----------------	----	--------------------