



## ★ GRA014-NPP-B-AS2/V

Radial insert ball bearing

Schaeffler ID:  
0502823870000

Radial insert ball bearing GRA...NPP-B-AS2/V

★ Preferred product

### Technical information

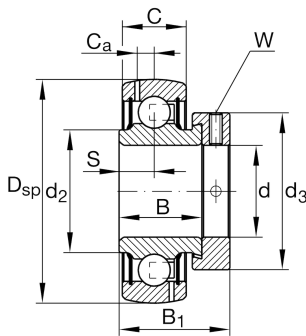

#### Main Dimensions & Performance Data

d	22,225 mm	Bore diameter
d	0.875 inch	Bore diameter, inch
D <sub>SP</sub>	52 mm	Outside diameter
B <sub>1</sub>	31 mm	Locking collar total width
B	21,4 mm	Width
C <sub>ur</sub>	410 N	Fatigue load limit, radial
C <sub>r</sub>	14.900 N	Basic dynamic load rating, radial
C <sub>0r</sub>	7.800 N	Basic static load rating, radial
	0,002 kg	Weight

#### Dimensions

C	15 mm	Width, outer ring
S	7,5 mm	Distance raceway
d <sub>2</sub>	30,3 mm	Rib diameter sealing inner ring
C <sub>a</sub>	3,9 mm	Distance to lubrication hole
d <sub>3</sub>	37,5 mm	Outside diameter locking collar/locknut
W	0.125 inch	Width across flats (Inch)

#### Calculation factors

f <sub>0</sub>	13,8	Calculation factor
----------------	------	--------------------