

★ LR50/8-2RSR

Track roller

Schaeffler ID:
0504738400000

Track rollers LR50, double row, sealed on both sides

★ Preferred product

Technical information

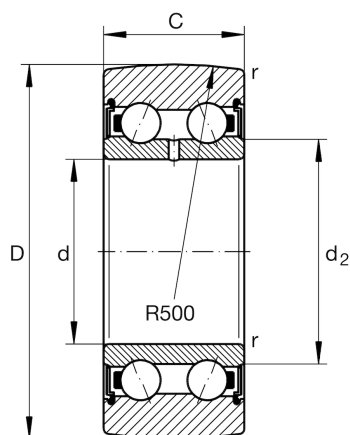

Main Dimensions & Performance Data

| | | |
|-------------|--------------|---|
| D | 24 mm | Outside diameter |
| d | 8 mm | Bore diameter |
| C | 11 mm | Height |
| $C_{r w}$ | 4.300 N | Basic dynamic load rating, radial |
| $C_{0r w}$ | 2.460 N | Basic static load rating, radial |
| $C_{ur w}$ | 122 N | Fatigue load limit, radial |
| n_{DG} | 10.000 1/min | Speed on permanent grease lubrication |
| $F_{r per}$ | 2.460 N | Permissible dynamic load outer ring, radial |
| | 0,03 kg | Weight |

Dimensions

| | | |
|-----------|---------|--------------------------------------|
| d_2 | 10,5 mm | Diameter of thrust washer |
| r_{min} | 0,3 mm | Minimum chamfer dimension |
| R | 500 mm | Radius of outer ring outside profile |