

★ NA4909-XL

Radial roller bearing

Schaeffler ID:
0506511530000

Radial roller bearing NA..-XL

★ Preferred product

X-life

Technical information

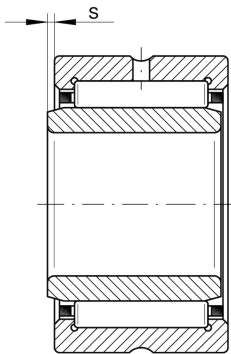
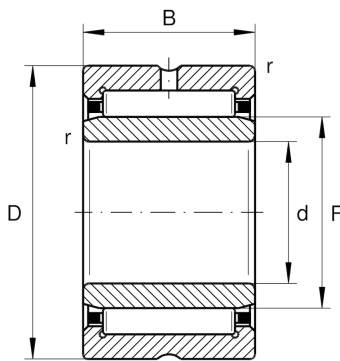

Temperature range

| | | |
|------------|----------|----------------------------|
| T_{\min} | -30 °C | Operating temperature min. |
| T_{\max} | 120 °C | Operating temperature max. |
| | 0,003 kg | Weight |

Main Dimensions & Performance Data

| | | |
|------------------------|-------------|---------------------------------------|
| d | 45 mm | Bore diameter |
| D | 68 mm | Outside diameter |
| B | 22 mm | Width |
| C_r | 51.000 N | Basic dynamic load rating, radial |
| C_{0r} | 73.000 N | Basic static load rating, radial |
| C_{ur} | 12.900 N | Fatigue load limit, radial |
| n_G | 8.600 1/min | Limiting speed |
| $n_{G \text{ Grease}}$ | 5.200 1/min | Limiting speed for grease lubrication |
| n_{gr} | 4.700 1/min | Reference speed |

Dimensions

| | | |
|------------|--------|-----------------------------|
| r_{\min} | 0,6 mm | Minimum chamfer dimension |
| F | 52 mm | Raceway diameter inner ring |
| s | 1 mm | Axial displacement |