

★ KWVE35-B-SL

Recirculating ball bearing carriage

Schaeffler ID:  
0183567530240

Carriages KWVE...-B-SL, narrow, long  
carriage, four-row

★ Preferred product

Technical information

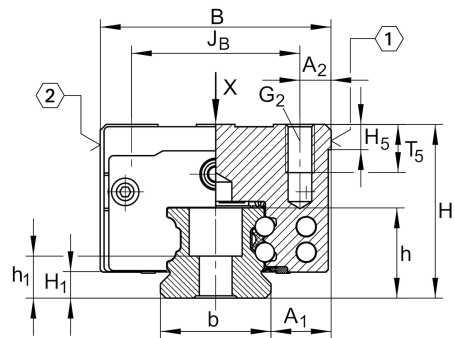

Main Dimensions & Performance Data

|                 |           |                                   |
|-----------------|-----------|-----------------------------------|
| H               | 48 mm     | height system                     |
| B               | 70 mm     | width carriage                    |
| L               | 145 mm    | overall length carriage           |
| C               | 47.500 N  | dynamic load rating               |
| C <sub>0</sub>  | 100.000 N | static load rating                |
| M <sub>0x</sub> | 2.625 Nm  | static moment rating about X axis |
| M <sub>0y</sub> | 1.890 Nm  | static moment rating about Y axis |
| M <sub>0z</sub> | 1.890 Nm  | static moment rating about Z axis |
|                 | 2,006 kg  | Weight                            |

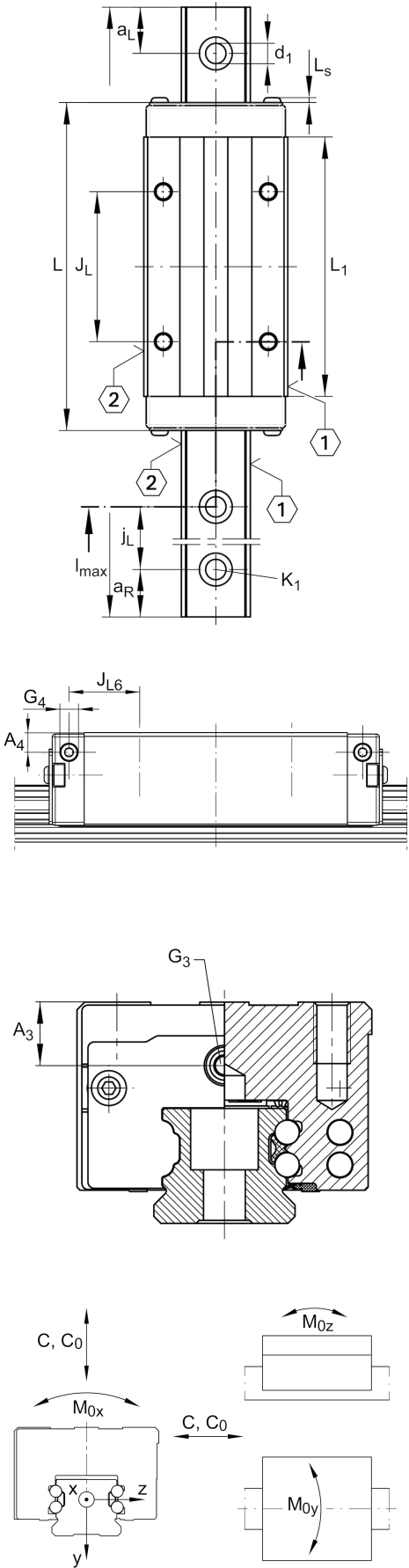

Mounting dimensions

| VMKB_065  | KWVE    | Material name  |
|-----------|---------|--|
| $A_1$     | 18 mm   |  |
| $J_B$     | 50 mm   |  |
| $b$       | 34 mm   | width rail   |
| $A_2$     | 10 mm   |  |
| $L_1$     | 113 mm  |  |
| $L_s$     | 1,65 mm |  |
| $J_L$     | 72 mm   |  |
| $H_1$     | 6,7 mm  |  |
| $H_5$     | 6,75 mm |  |
| $T_5$     | 13,5 mm |  |
| $G_2$     | M8      | fixing screws below (DIN ISO 4762-12.9)                    |
| $G_2 M_A$ | 41 Nm   | maximum tightening torque                                  |
| $A_3$     | 12,3 mm | position lubrication connector                             |
| $G_3$     | M6      | lubrication connector                                      |
| $t G_3$   | 7 mm    | maximum permissible screw depth for lubrication connectors |
| $A_4$     | 11 mm   | position lubrication connector                             |
| $G_4$     | M6 mm   | lubrication connector                                      |
| $t G_4$   | 7 mm    | maximum permissible screw depth for lubrication connectors |
| $J_{L6}$  | 27,5 mm | position lubrication connector                             |

