

IE-C6FP8LD0050M40V40-D

Weidmüller Interface GmbH & Co. KG
Klingenbergstraße 26
D-32758 Detmold
Germany

www.weidmueller.com



Assembled IE cables, patch cable Cabinet Line, Cat. 6,
LSZH, grey, 90° angled on one side

General ordering data

| | |
|------------|---|
| Version | Patch cable, RJ45 IP 20, RJ45 IP 20, Angled 90°, <20 m: Cat.6A / >20 m Class EA (ISO/IEC 11801 2010), LSZH, 5 m |
| Order No. | 1248280050 |
| Type | IE-C6FP8LD0050M40V40-D |
| GTIN (EAN) | 4050118044690 |
| Qty. | 1 pc(s). |

Creation date March 13, 2023 12:44:47 PM CET

Catalogue status 03.03.2023 / We reserve the right to make technical changes.

IE-C6FP8LD0050M40V40-D

Weidmüller Interface GmbH & Co. KG

Klingenbergstraße 26

D-32758 Detmold

Germany

www.weidmueller.com

Technical data

Dimensions and weights

| | | | |
|------------|-------|-----------------|-------------|
| Length | 5 m | Length (inches) | 196.85 inch |
| Net weight | 199 g | | |

Temperatures

| | | | |
|-----------------------------|----------------|-----------------------------|----------------|
| Storage temperature | -20 °C...60 °C | Operating temperature | -20 °C...60 °C |
| Operating temperature, min. | -20 °C | Operating temperature, max. | 60 °C |
| Installation temperature | 0 °C...50 °C | | |

Electrical properties

| | | | |
|------------------------------------|-----|------------|----------------------------|
| Current-carrying capacity at 50 °C | 1 A | PoE / PoE+ | conforming to IEEE 802.3at |
|------------------------------------|-----|------------|----------------------------|

General standards

| | | | |
|---|---|-------------------------|---------|
| Application-specific communication cable facilities | ANSI / TIA / EIA-568-B.2-10, ISO / IEC 11801:2002, EN50173-1:2007 | Certificate no. (cULus) | E316369 |
| Connector standard | IEC 60603-7-5 1 | | |

Standards

| | |
|--------------------|-----------------|
| Connector standard | IEC 60603-7-5 1 |
|--------------------|-----------------|

Cable structure

| | | | |
|----------------------------|---|---------------------------------------|--|
| Arrangement of wire cores | Twisted pair | Colour sequence or wires - wire pairs | white - blue, white - orange, white - green, white - brown |
| Complete shielding | Shielding braid made from copper wiring | Cross-section | 4*2*AWG 27/7 - 4*2*0.1 mm ² |
| Insulation | PE | Insulation cross-section | 1.04 mm |
| Material sheath | LSZH | Number of wires | 8 |
| Overlap of shielding braid | 60 % | Sheath diameter, max. | 5.9 mm |
| Sheath diameter, min. | 5.5 mm | Sheathing colour | grey |
| Shielding | S/FTP | Strands | 7 |
| Wire pair shielding | Aluminium foil | | |

Electrical properties of cable

| | | |
|-------------------------------------|---|--------|
| Capacity at 1 kHz | 46 nF/km | |
| Category | <20 m: Cat.6A / >20 m Class EA (ISO/IEC 11801 2010) | |
| Characteristic impedance | 100 ± 15 Ω at 1–100 MHz | |
| Coupling attenuation up to 1000 MHz | 80 dB | |
| Coupling resistance at 10 MHz | 5 mΩ/m | |
| Deviation | 2.5 ns/100m | |
| Operating voltage | 50 V DC | |
| Operating voltage (UL rating) | Operating voltage | 30 V |
| | Voltage type | AC |
| | Operating voltage | 42.4 V |
| | Voltage type | DC |
| Operating voltage (UL rating) | 30 V AC / 42.4 V DC | |
| Operating voltage, UL | 30 V AC / 42.4 V DC | |
| Resistance differential | 5 % | |

Creation date March 13, 2023 12:44:47 PM CET

Catalogue status 03.03.2023 / We reserve the right to make technical changes.

2

IE-C6FP8LD0050M40V40-D

Weidmüller Interface GmbH & Co. KG

Klingenbergstraße 26

D-32758 Detmold

Germany

www.weidmueller.com

Technical data

| | |
|--|-----------------------|
| Separating class according to EN 50174-2 | d |
| Speed | 10 GBit/s |
| Test voltage: wire-wire-shield | 2.5 kV / DC for 2 sec |

Mechanical and material properties of cable

| | | | |
|--------------------------------|--------------------|-------------------------------|---|
| Colour | grey | Halogen | halogen-free, according to IEC 60754-2 |
| Min. bending radius, once only | | Resistance to spread of flame | in accordance with IEC 60332-2-2, in accordance with IEC 60332-1-2, in accordance with IEC 60332-3-24, in accordance with UL 2556 (FT1) |
| | 5 x cable diameter | | |
| Speed | 10 GBit/s | | |

Plug

| | | | |
|-----------|---|------------|---|
| Plug left | RJ45, IP20, male contact, straight, plug, Plastic, shielded | Plug right | RJ45, IP20, male contact, angled 90°, plug, Plastic, shielded |
|-----------|---|------------|---|

Plug, left

| | |
|----------------|------------|
| Connector left | RJ45 IP 20 |
|----------------|------------|

Plug, right

| | | | |
|-----------------------|------------------------|-----------------|-------------|
| Connector right | RJ45 IP 20, Angled 90° | Contact surface | Au ≥ 0.8 µm |
| Housing main material | PC UL 94 V0 | Plugging cycles | 750 |

Classifications

| | | | |
|-------------|-------------|-------------|-------------|
| ETIM 6.0 | EC002599 | ETIM 7.0 | EC002599 |
| ETIM 8.0 | EC002599 | ECLASS 9.0 | 27-06-03-08 |
| ECLASS 9.1 | 27-06-03-08 | ECLASS 10.0 | 27-06-03-08 |
| ECLASS 11.0 | 27-06-03-08 | ECLASS 12.0 | 27-06-03-08 |

Approvals

Approvals



| | |
|-------------------------|------------|
| ROHS | Conform |
| UL File Number Search | UL Website |
| Certificate no. (cULus) | E316369 |

IE-C6FP8LD0050M40V40-D

Weidmüller Interface GmbH & Co. KG
Klingenbergstraße 26
D-32758 Detmold
Germany

www.weidmueller.com

Technical data

Downloads

| | |
|---|---|
| Approval/Certificate/Document of Conformity | ISO/IEC EN and TIA/EIA Screened Class EA Category 6A, 2 connector channel DUXR.E316369 Control - CC-Link Patchcord Certificate Field - CC-Link Patchcord Certificate TSN - CC-Link Patchcord Certificate |
| Engineering Data | CAD data – STEP |
| Product Change Notification | PCN-PB47-20180213-00-A_EN PCN-PB47-20180213-00-A_DE |
| User Documentation | MAN IE GUIDE DE MAN IE GUIDE EN |
| Catalogues | Catalogues in PDF-format |
| Brochures | FL FIELDWIRING EN PI PROFINET CABLING EN PI PROFINET CABLING EN |

IE-C6FP8LD0050M40V40-D

Weidmüller Interface GmbH & Co. KG
 Klingenbergstraße 26
 D-32758 Detmold
 Germany

www.weidmueller.com

Drawings

Wiring

| | | | | |
|------|---|----------------|---|------|
| RJ45 | 1 | white (orange) | 1 | RJ45 |
| | 2 | orange | 2 | |
| | 3 | white (green) | 3 | |
| | 4 | blue | 4 | |
| | 5 | white (blue) | 5 | |
| | 6 | green | 6 | |
| | 7 | white (brown) | 7 | |
| | 8 | brown | 8 | |

Dimensioned drawing

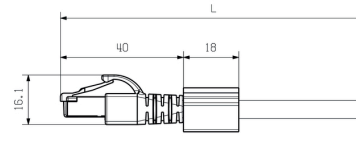

Dimensioned drawing

