

SM 18/9.5 K MC NE GE

Weidmüller Interface GmbH & Co. KG

Klingenbergstraße 26

D-32758 Detmold

Germany

www.weidmueller.com

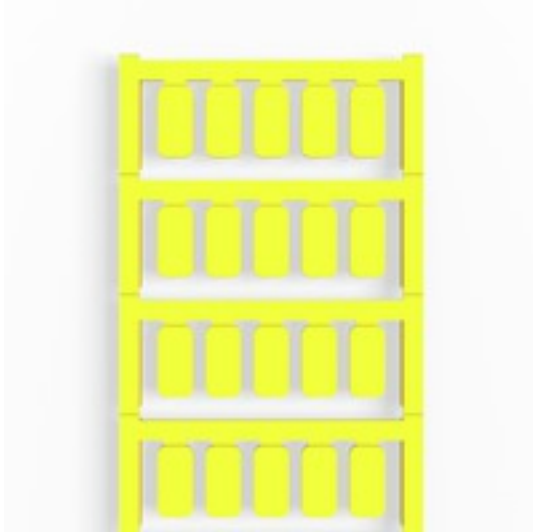

SM is a MultiCard marker for labelling control and signalling devices. The tags are clipped into the carriers or attached by means of the adhesive film already fitted to them. Customised tags can be created with the PrintJet CONNECT or Plotter marking systems.

- Users can quickly produce tags to suit their needs
- No need to stock expensive standard tags
- Highly resistant printing quality when using the PrintJet as a substitute for engraving
- For extreme demands, we recommend the ETO SM protective film
- Holders can be used for the 22-mm or 30-mm-diameter push-buttons from Siemens, ABB, Moeller and Télémécanique

For custom printing: Please send us a file of our labeling software M-Print PRO or M-Print PRO Online (without installation) for your labeling specifications.

General ordering data

Version	SwitchMark, Device markers, 9.5 x 18 mm, Siemens 3 SB, yellow
Order No.	1248590000
Type	SM 18/9.5 K MC NE GE
GTIN (EAN)	4050118038958
Qty.	200 pc(s).
compatible printer	2715590000 2438520000 2438510000

SM 18/9.5 K MC NE GE**Weidmüller Interface GmbH & Co. KG**

Klingenbergstraße 26

D-32758 Detmold

Germany

www.weidmueller.com

Technical data**Dimensions and weights**

Depth	1 mm	Depth (inches)	0.039 inch
Height	9.5 mm	Height (inches)	0.374 inch
Width	18 mm	Width (inches)	0.709 inch
Net weight	0.57 g		

Temperatures

Operating temperature range	-40...60 °C
-----------------------------	-------------

General data

Adhesive	Double-sided adhesive tape	Application/manufacturer	Siemens 3 SB
Colour	yellow	Halogen	No
Material	Polyamide 66	Material colour according to resistance code	4
Number of markers per combination	1 MultiCard = Device markers	Operating temperature range	-40...60 °C
Operating temperature range, max.	60 °C	Operating temperature range, min.	-40 °C
UL 94 flammability rating	V-2	Version	Self-adhesive
Width	18 mm		

Device markers

Halogen	No
---------	----

Classifications

ETIM 6.0	EC001288	ETIM 7.0	EC001288
ETIM 8.0	EC001288	ECLASS 9.0	27-40-06-29
ECLASS 9.1	27-40-06-29	ECLASS 10.0	27-40-06-29
ECLASS 11.0	27-28-11-04	ECLASS 12.0	27-28-11-04

Approvals

ROHS	Conform
------	---------

Downloads

Engineering Data	CAD data – STEP
Engineering Data	WSCAD
Catalogues	Catalogues in PDF-format

Data sheet

SM 18/9.5 K MC NE GE

Weidmüller Interface GmbH & Co. KG
Klingenbergstraße 26
D-32758 Detmold
Germany

www.weidmueller.com

Drawings

Example of use

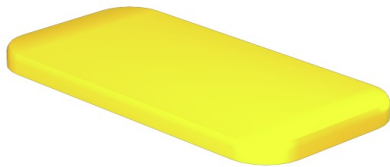

Similar to illustration

