

**IE-BS-V01M-LCD-MM-C****Weidmüller Interfaces GmbH & Co. KG**

Postfach 3030

32760 Detmold

Tel. +49 5231 14-0

Fax. +49 5231 14-2083

info@weidmueller.com

www.weidmueller.com



Bayonet plug-in connector sets according to IEC  
61076-3-106 ver.1 (EtherNet/IP), RJ45 metal insert incl.  
LC insert

**General ordering data**

Version	Flange FO, IP67, Version 1, LC Duplex coupling, Multimode
Order No.	<a href="#">1964440000</a>
Type	IE-BS-V01M-LCD-MM-C
GTIN (EAN)	4032248649051
Qty.	10 Stück

## IE-BS-V01M-LCD-MM-C

**Weidmüller Interfaces GmbH & Co. KG**

Postfach 3030

32760 Detmold

Tel. +49 5231 14-0

Fax. +49 5231 14-2083

info@weidmueller.com

www.weidmueller.com

## Technische Daten

### Dimensions and weights

Depth	33.3 mm	Depth (inches)	1.311 inch
Height	32 mm	Height (inches)	1.26 inch
Width	32 mm	Width (inches)	1.26 inch
Net weight	60.1 g		

### Temperatures

Operating temperature	-40 °C...70 °C	Operating temperature, min.	-40 °C
Operating temperature, max.	70 °C		

### General data

Colour	Miscellaneous	Connection 1	LC Duplex
Connection 2	LC Duplex	Description of article	Version 1, LC Duplex coupling
Fibre type	Multimode	Housing main material	Zinc diecast
Insertion loss	≤ 0.4 dB	Plugging cycles	500
Protection degree	IP67	Return loss (attenuation)	≥ 30 dB

### General standards

Connector standard	IEC 61076-3-106 Var. 1, IEC 61754-20
--------------------	---

### Classifications

ETIM 6.0	EC001122	ETIM 7.0	EC001122
ETIM 8.0	EC001122	ECLASS 9.0	19-17-01-22
ECLASS 9.1	19-17-01-22	ECLASS 10.0	19-17-01-22
ECLASS 11.0	19-17-01-22	ECLASS 12.0	19-17-01-22

### Environmental Product Compliance

REACH SVHC	Lead 7439-92-1
SCIP	67cf1078-beca-4687-860b-dc475a6ec24a

### Approvals

ROHS	Conform
------	---------

## IE-BS-V01M-LCD-MM-C

Weidmüller Interfaces GmbH & Co. KG

Postfach 3030

32760 Detmold

Tel. +49 5231 14-0

Fax. +49 5231 14-2083

[info@weidmueller.com](mailto:info@weidmueller.com)

[www.weidmueller.com](http://www.weidmueller.com)

## Technische Daten

### Downloads

Approval/Certificate/Document of Conformity

[GOST Approval](#)

Engineering Data

[CAD data – STEP](#)

Engineering Data

[WSCAD](#)

Product Change Notification

[Technical change to Bulkhead Variant 1 \(Metal\) - EN](#)

[Technical change to Bulkhead Variant 1 \(Metal\) - DE](#)

[20190724 Technische Änderung zu Flansch Variante 1 \(Metall\)](#)

[20190724 Technische Änderung zu Flansch Variante 1 \(Metall\)](#)

[20190724 Technical change to Bulkhead Variant 1 \(Metal\)](#)

User Documentation

[MAN IE GUIDE DE](#)

[MAN IE GUIDE EN](#)

[Designation key / Type key](#)

[Manual](#)

Catalogues

[Catalogues in PDF-format](#)

Brochures

[FL FIELDWIRING EN](#)

[PI PROFINET CABLING EN](#)

[PI PROFINET CABLING EN](#)

## IE-BS-V01M-LCD-MM-C

Weidmüller Interfaces GmbH & Co. KG

Postfach 3030

32760 Detmold

Tel. +49 5231 14-0

Fax. +49 5231 14-2083

info@weidmueller.com

www.weidmueller.com

## Zeichnungen

### Installation cut-out

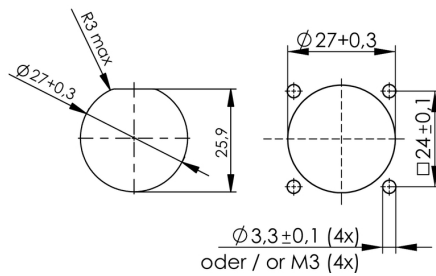

Mounting cut-out: 1. With central screw connection / 2. For mounting with four M3 screws