

**IE-BHD-V04P****Weidmüller Interface GmbH & Co. KG**

Klingenbergstraße 26

D-32758 Detmold

Germany

www.weidmueller.com



PushPull plug-in connector according to IEC  
61076-3-106 ver.4 (IEC24702), plastic, empty housing

**General ordering data**

Version	Device flange, Variant 4 to IEC 61076-3-106, IP67
Order No.	<a href="#">2027660000</a>
Type	IE-BHD-V04P
GTIN (EAN)	4050118406061
Qty.	200 pc(s).

Creation date March 9, 2023 7:08:38 PM CET

Catalogue status 03.03.2023 / We reserve the right to make technical changes.

## IE-BHD-V04P

Weidmüller Interface GmbH &amp; Co. KG

Klingenbergstraße 26

D-32758 Detmold

Germany

www.weidmueller.com

## Technical data

## Dimensions and weights

Depth	15.5 mm	Depth (inches)	0.61 inch
Height	22.3 mm	Height (inches)	0.878 inch
Width	32 mm	Width (inches)	1.26 inch
Wall thickness, max.	3.5 mm	Net weight	0.01 g

## Temperatures

Operating temperature	-40 °C...70 °C	Operating temperature, min.	-40 °C
Operating temperature, max.	70 °C		

## General data

Colour	Miscellaneous	Housing main material	PA UL 94 V0
Protection degree	IP67	UL 94 flammability rating	V-0

## General standards

Certificate no. (cULus)	E471884	Connector standard	IEC 61076-3-106 Var. 4
-------------------------	---------	--------------------	------------------------

## Classifications

ETIM 6.0	EC001031	ETIM 7.0	EC001031
ETIM 8.0	EC001031	ECLASS 9.0	27-18-27-02
ECLASS 9.1	27-18-27-02	ECLASS 10.0	27-18-27-02
ECLASS 11.0	27-18-27-02	ECLASS 12.0	27-18-27-02

## Approvals

Approvals



ROHS	Conform
UL File Number Search	UL Website
Certificate no. (cULus)	E471884

## Downloads

Engineering Data	<a href="#">CAD data – STEP</a>
User Documentation	<a href="#">Mounting instruction_2027660000-IE-BHD-V04P.pdf</a> <a href="#">MAN IE GUIDE DE</a> <a href="#">MAN IE GUIDE EN</a> <a href="#">Designation key / Type key</a>
Catalogues	<a href="#">Catalogues in PDF-format</a>
Brochures	<a href="#">MB FREECONTACT EN</a> <a href="#">FL FIELDWIRING EN</a> <a href="#">PI PROFINET CABLING EN</a> <a href="#">PI PROFINET CABLING EN</a>

IE-BHD-V04P

Weidmüller Interface GmbH & Co. KG  
Klingenbergstraße 26  
D-32758 Detmold  
Germany

www.weidmueller.com

Drawings

Drawing

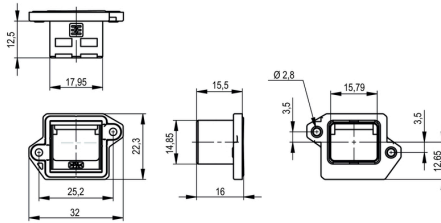

Installation cut-out

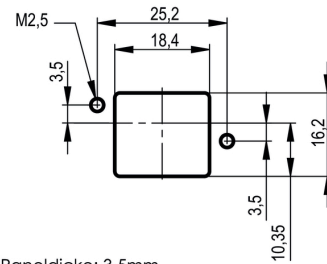

max. Paneldicke: 3,5mm  
max. Panel thickness: 3,5 mm

M2,5 Gewinde darf kein Sackloch sein  
M2.5 threads mustn't go through the panel