

Linear Guides for Heavy Load

With Plastic Retainers, Interchangeable, Light Preload

= For customers using industry standard products =
 Frame-surrounded products are compliant with the industry standard specifications (Standard Block Type).
 Select the block from this spec.

■ **Features:** Linear Guides with Plastic Retainers prevent contact between balls and result in low noise levels under high-speed operation.

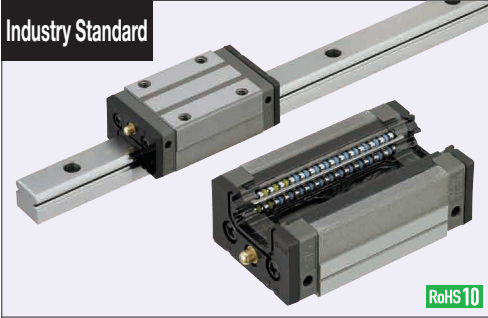

	Type		Block	Rail	L Dimension	Material Hardness
	1 block	2 blocks				
Standard	SXRZ	SX2RZ	SXRZ	SRZL	Selectable	Carbon Steel 58HRC~
	SXRLZ	SX2RLZ		SRZLF	Configurable	
	SXWZ	SX2WZ		SRZL	Selectable	
Wide Block Through Hole	SXWLZ	SX2WLZ	SXWB	SRZLF	Configurable	
	SXWTZ	SX2WTZ	SXWB	SRZL	Selectable	
Wide Block Tapped Hole	SXWTLZ	SX2WTLZ	SXWTB	SRZLF	Configurable	

Heat Resistant Temperature: 0 ~ 50°C

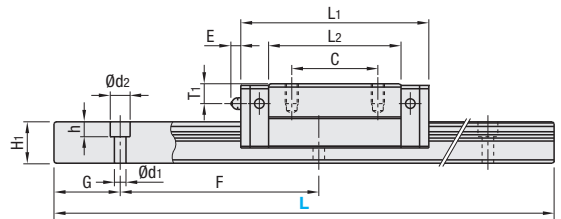
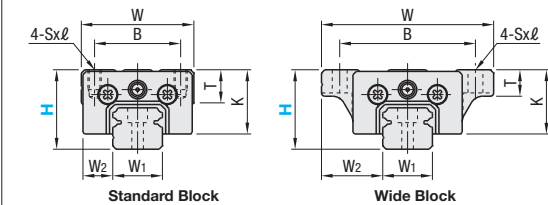
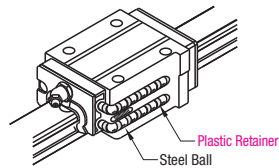

⚠ For L Configurable, G dimensions differ from those shown in the table below. For details, see P.531.

- **Precautions for Use**
- Blocks are equipped with retainers to prevent balls from falling off. For how to handle the blocks, see P.525.
 - For interchangeable, Light Preload Type, rails and blocks can be interchanged.
 - Straight grooves are provided on datum planes. Be sure to match the datum lines when using.
 - Rails cannot be connected end to end.
 - The accuracy of Linear Guides is guaranteed after mounting the rail (after fastening screws on the rail and pushing it onto the datum plane).
 - Minor bending of the rail will be adjusted after being mounted and will not affect the performance.

- **Others**
- Filled with Lithium soap based grease (Alvania Grease S2 by Showa Shell Sekiyu K.K.).
 - Grease Fittings: Straight Type for H24 and Angled Type for H28, H33 and H42.
 - Grease Fitting is screw-in type, and thus, can be repositioned.
 - For Operating Life Calculation, see P.527
 - For operating life calculations, use our free calculation software from http://download.misumi.jp/mol/fa_soft.html.

	Part Number		H	Block Dimension										Guide Rail Dimension							
	Type			W	L ₁	B	C	Sxℓ	L ₂	K	T	Grease Fitting			H ₁	W ₁	W ₂	Counterbore Hole d1xd2xh	F	G	
	1 block	2 blocks										Mounting Hole	E	T ₁							
Standard Block (Block)	SXRZ	SX2RZ	24	100-1480 (160)	34	56.8	26	26	M4x6	40	19.4	10	Ø3	3	6	12.5	15	9.5	3.5x6x4.5	60	20
	SXRLZ	SX2RLZ	28	160-1960 (220)	42	65.2	32	32	M5x7	48	22	12	M6xP0.75	11	5.5	15.5	20	11	6x9.5x8.5	60	20
	SXRZ	SX2RZ	33	160-1960 (220)	48	81.6	35	35	M6x9	60	26	12	M6xP0.75	11	7	18	23	12.5	7x11x9	60	20
	SXRZ	SX2RZ	42	200-1960 (280)	60	96.4	40	40	M8x12	71	33	13	M6xP0.75	11	8	23	28	16	7x11x9	80	20
Wide Block (Block)	SXWZ	SX2WZ	24	100-1480 (160)	52	56.8	41	26	4.5 (M5)	40	19.4	8	Ø3	3	6	12.5	15	18.5	3.5x6x4.5	60	20
	SXWLZ	SX2WLZ	28	160-1960 (220)	59	65.2	49	32	5.5 (M6)	48	22	10	M6xP0.75	11	5.5	15.5	20	19.5	6x9.5x8.5	60	20
	SXWTZ	SX2WTZ	33	160-1960 (220)	73	81.6	60	35	7 (M8)	60	26	11	M6xP0.75	11	7	18	23	25	7x11x9	60	20
	SXWTLZ	SX2WTLZ	42	200-1960 (280)	90	96.4	72	40	9 (M10)	71	33	11	M6xP0.75	11	8	23	28	31	7x11x9	80	20

⚠ L Dimension: Dimensions in () are for 2-Block Type.
 ⚠ Sxℓ Dimensions: Dimensions in () are for Wide Block Tapped Hole.

kgf=Nx0.101972

H	Basic Load Rating		Allowable Static Moment			Mass		
	C (Dynamic) kN	Co (Static) kN	MA N·m	Mb N·m	Mc N·m	Block kg Standard	Wide	Guide Rail kg/m
24	7.9	15.6	74	62	78	0.2	0.26	1.4
28	11.1	21.8	124	104	149	0.28	0.35	2.3
33	17.9	33.5	242	203	266	0.51	0.66	3.1
42	27.3	50.5	415	350	480	0.85	1.20	4.8

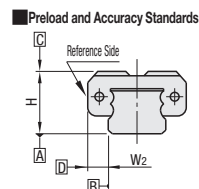

■ **Preload and Accuracy Standards**

Interchangeable, Light Preload Type

Radial Clearance (µm)	
H24, 28	-4~0
H33, 42	-5~0

Dimensional Accuracy (µm)		Interchangeable
Height H Tolerance	±20	
Pair Variation of Height H	15	
Width W ₂ Tolerance	±30	
Pair Variation of Width W ₂	25	
Running Parallelism of Plane C against Plane A	See	
Running Parallelism of Plane D against Plane B	P.525	

H	Selectable L	Unit Price									
		1 block			2 blocks			Rail	Block		
		SXRZ	SXWZ	SXWTZ	SX2RZ	SX2WZ	SX2WTZ	SRZL	SXRZ	SXWB	SXWTB
100											
160											
220											
280											
340											
400											
460											
520											
580											
640											
700											
760											
820											
880											
940											
1000											
1060											
1120											
1180											
1240											
1300											
1360											
1420											
1480											
160											
220											
280											
340											
400											
460											
520											
580											
640											
700											
760											
820											
880											
940											
1000											
1060											
1120											
1180											
1240											
1300											
1360											
1420											
1480											
160											
220											
280											
340											
400											
460											
520											
580											
640											
700											
760											
820											
880											
940											
1000											
1060											
1120											
1180											
1240											
1300											
1360											
1420											
1480											
160											
220											
280											
340											
400											
460											
520											
580											
640											
700											
760											
820											
880											
940											
1000											
1060											
1120											
1180											
1240											
1300											
1360											
1420											
1480											
160											
220											
280											
340											
400											
460											
520											
580											
640											
700											
760											
820											
880											
940											
1000											
1060											
1120											
1180											
1240											
1300											
1360											
1420											
1480											
160											
220											
280											
340											
400											
460											
520											
580											
640											
700											
760											
820											
880											
940											