

# Roller Carriers (Cantilever Type for Guiding)

# Roller Carriers (Zigzag Type)

■ **Features:** Cantilever Type does not take up lot of space, and is a product for Guiding.

## ■ Cantilever Type

Type		Material			Surface Treatment				
P=30	P=35	① Rollers	Bearing	② Frame	③ Screw, Nut	① Rollers	② Frame	③ Screw, Nut	
<b>CRONK</b>	<b>CRONKF</b>	Steel			① Trivalent Chromate	② Trivalent Chromate	③ Trivalent Chromate		
<b>CROJK</b>	<b>CROJKF</b>	Polyacetal		Steel	-	Trivalent Chromate	Trivalent Chromate	Trivalent Chromate	

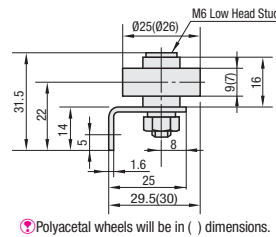

Ⓜ Polyacetal wheels will be in ( ) dimensions.

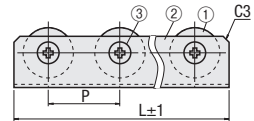

■ Number of mounting holes varies depending on the overall length (L).

• In case of 2 mounting holes  
⇒ Hole near the center of the following diagram is not machined.

• In case of 3 mounting holes  
• In case of even number of wheels

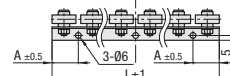

• In case of odd number of wheels

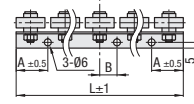

A=27.5(CRONK, CROJK)  
A=32.5(CRONKF, CROJKF)  
B=15(CRONK, CROJK)  
B=17.5(CRONKF, CROJKF)

## ■ Allowable Load per Wheel

Wheel Material	Allowable Load
Steel	30kgf(294N)
Polyacetal	20kgf(196N)

## ■ Cantilever Type

Part Number	Overall Length (L)	Unit Price	
		P=30	P=35
<b>CRONK</b>			
<b>CRONKF</b>			
(Steel)			
<b>CROJK</b>			
<b>CROJKF</b>			
(Polyacetal)			
3	85	100	
4	115	135	
5	145	170	
6	175	205	
7	205	240	
8	235	275	
9	265	310	
10	295	345	
11	325	380	
12	355	415	
13	385	450	
14	415	485	
15	445	520	
16	475	555	
17	505	590	
18	535	625	
19	565	660	
20	595	695	
21	625	730	
22	655	765	
23	685	800	
24	715	835	
25	745	870	
26	775	905	
27	805	940	
28	835	975	
29	865	-	-
30	895	-	-
31	925	-	-
32	955	-	-
33	985	-	-



Ordering Example Part Number - Number of Wheels  
**CRONK** - 20



Alterations Part Number - Number of Wheels - (CC)  
**CRONK** - 20 - CC

Alterations	Code	Spec.
	CC	Chamfer frame corners
	CC	Change dimensions.
	CC	Change C3 to C8

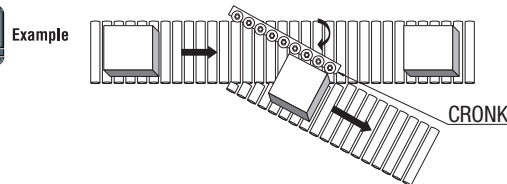

■ **Features:** Zigzag Type has short pitch, and is a product that reduces backlash of work.

## ■ Zigzag Type

Type		Material			Surface Treatment				
P=20	P=25	① Rollers	Bearing	② Frame	③ Screw, Nut	① Rollers	② Frame	③ Screw, Nut	
<b>CRONM</b>	<b>CROJM</b>	Steel			① Trivalent Chromate	② Trivalent Chromate	③ Trivalent Chromate		
		Polyacetal		Steel	-	Trivalent Chromate	Trivalent Chromate	Trivalent Chromate	

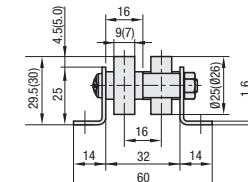

Ⓜ Polyacetal wheels will be in ( ) dimensions.

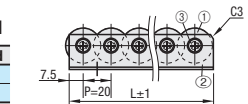

■ Number of mounting holes varies depending on the overall length (L).

• In case of 4 mounting holes  
⇒ Hole near the center of the following diagram is not machined.

• In case of 6 mounting holes  
• In case of even number of wheels

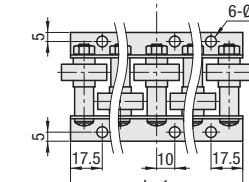
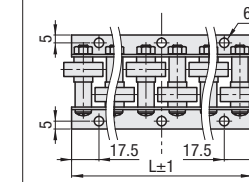

## ■ Allowable Load per Wheel

Wheel Material	Allowable Load
Steel	30kgf(294N)
Polyacetal	20kgf(196N)

## ■ Zigzag Type

Part Number	Overall Length (L)	Unit Price	
		Pitch x Quantity	CRONM CROJM
Type	Wheel Qty.	Pitch x Quantity	
		P=20	
	3	55	
	4	75	
	5	95	
	6	115	
	7	135	
	8	155	
	9	175	
	10	195	
	11	215	
	12	235	
	13	255	
	14	275	
	15	295	
	16	315	
	17	335	
	18	355	
	19	375	
	20	395	
	21	415	
	22	435	
	23	455	
	24	475	
	25	495	

Zigzag Type

**CRONM**

(Steel)

**CROJM**

(Polyacetal)

Part Number	Overall Length (L)	Unit Price	
		Pitch x Quantity	CRONM CROJM
Type	Wheel Qty.	Pitch x Quantity	
		P=20	
	26	515	
	27	535	
	28	555	
	29	575	
	30	595	
	31	615	
	32	635	
	33	655	
	34	675	
	35	695	
	36	715	
	37	735	
	38	755	
	39	775	
	40	795	
	41	815	
	42	835	
	43	855	
	44	875	
	45	895	
	46	915	
	47	935	
	48	955	
	49	975	
	50	995	

Zigzag Type

**CRONM**

(Steel)

**CROJM**

(Polyacetal)



Ordering Example Part Number - Number of Wheels  
**CRONK** - 20



Alterations Part Number - Number of Wheels - (CC)  
**CRONK** - 20 - CC

Alterations	Code	Spec.
	CC	Chamfer frame corners
	CC	Change dimensions.
	CC	Change C3 to C8