

# Flat Belt Conveyor Motor Integrated Type

## 3-Groove Frame (Pulley Dia. 70mm)

Dedicated web site <http://fa.misumi.jp/cvs/>  
 Conveyor selecting, component purchases, and easy search for maintenance parts are available.

■ **Features:** Crowned pulleys suppress meandering. The unit height has been reduced by half with the motor integrated in the frame.

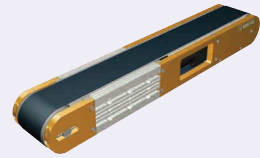

### CVSMA

#### 6W Motor Type

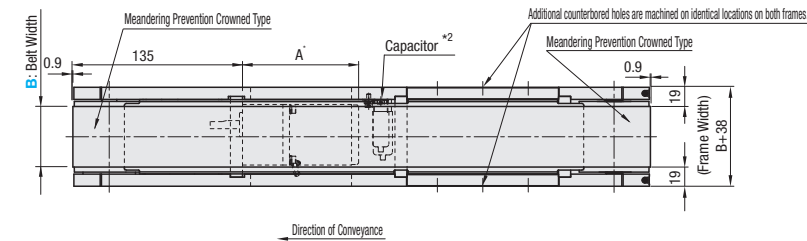

	Frame	Pulley Holder
<b>M</b> Material	Aluminum	EN AW-5052 Equiv.
<b>S</b> Surface Treatment	Clear Anodize	Gold Anodize

#### Frame Cross Section - Enlarged (Vertically Symmetrical)

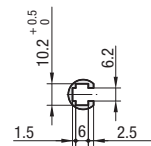
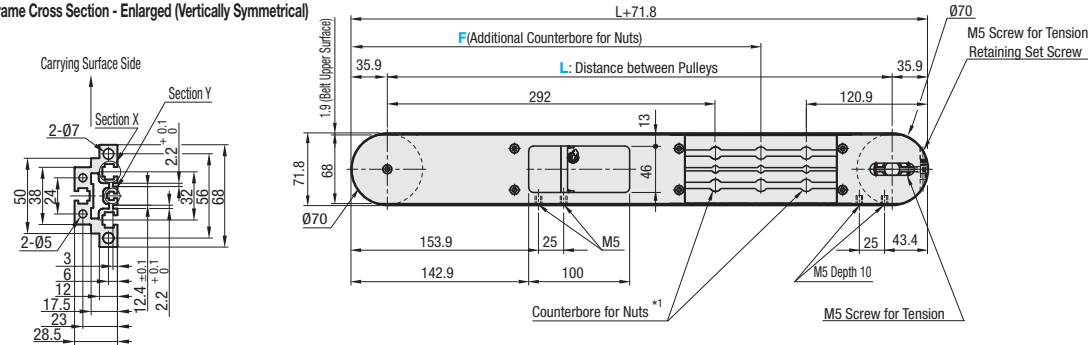

Part X (for M6)

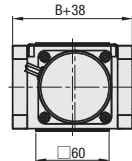

Motor Mounting Details

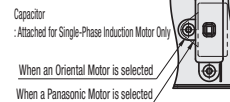

Capacitor Mounting Details

⚠ The dimensions in the diagram is for Belt Specifications H (0.9mm THK.). Take note that belt thickness varies by Belt Specifications, see **P.1279**~.

\*1 When  $L \leq 815$ , counterbores for the nuts will not be provided. However, each slot has 4 pre-inserted nuts provided.

\*2 Single-phase induction motor only.

⚠ Compatible with JIS standard hex nuts.

#### \* A Dimension Details

Motor		Reduction Ratio	A
Induction Motor	Panasonic	15~25	101.0
		30~180	108.0
	Oriental	15~18	105.0
		25~180	115.0
Variable Speed Motor	Panasonic	15~25	111.0
		30~180	118.0
	Oriental	15~18	115.0
		25~180	125.0

#### ■ Conveying Capacity

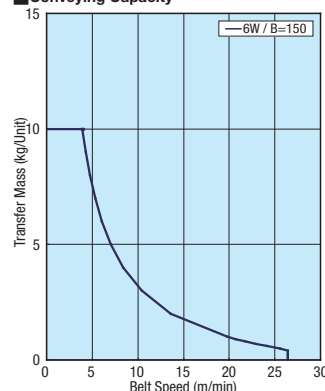

\*Reference Value may differ by selected Belt.

#### ■ Gearhead Reduction Ratio

\*May decrease depending on load condition.

Gearhead Reduction Ratio	Belt Speed (m/min)	
	50Hz	60Hz
15	22.0	26.4
18	18.3	22.0
25	13.2	15.8
30	11.0	13.2
36	9.2	11.0
50	6.6	7.9
60	5.5	6.6
75	4.4	5.3
90	3.7	4.4
100	3.3	4.0
120	2.7	3.3
150	2.2	2.6
180	1.8	2.2

Part Number	B Selection	L 5mm Increment	Motor				Belt Specification	F (Additional Counterbores) 5mm Increment	Motor Manufacturer Selection
			Output (W)	Voltage (V)	Specification	Gearhead Reduction Ratio			
CVSMA	60	415~2000	6	TA230 (Single-phase)	IM (Induction Motor) SCM (Variable Speed Motor)	15 18 25 30 36	H (General Purpose, Green) W (General Purpose, White) G (For Sliding, Green) S (For Sliding, White) D (For Electronic Parts Transfer) F (For Food Transfer) O (Oil Resistant) N (Non-adhesive) J (No Belt)	380<F<L-100 *When not specified, there will be no additional counterbores.	A (Panasonic Motor) B (Oriental Motor)
	100					120 150 180			
150	NV (No Motor)		NM (No Motor)	NH (No Gearhead)	R (No Motor, Gearhead)				

⚠ Connect the motor so that the belt rotates in the direction of conveyance. For connection diagram and motor details, see **P.1267** onward.  
 ⚠ When "No motor, gearhead" is selected, the motor mounting hole pitch will vary depending on the motor's power rating. Please see Technical Information in our Conveyor Selection web site for the dimension details.  
 ⚠ When "No motor, gearhead" is selected, this unit will be delivered unassembled. The customer is to assemble the unit according to the included assembly instructions. See our Conveyor Selection site for assembly procedures and packaging details.

Belt Specification	Standard Belt (Body Price Only)	Optional Belt 1	Optional Belt 2	No Belt
General Purpose	H (Green), W (White), HG (Green)	-	HY (Yellow Green), HBN (Sky Blue), HGN (Green)	J (No Belt)
For Sliding	G (Green), S (White)	-	-	
Grip Type	-	GG (Green), GW (White)	GSN (Green)	
Oil Resistant	O (Navy Blue), OH (Green), OG (Green)	OW (White)	ON (White)	
Non-adhesive	N (White), NS (White)	NB (Sky Blue), NBG (Lime Green), HH (Green), HW (White)	-	
For Food Transfer	F (White)	KW (White), KSB (Sky Blue)	-	
For Electronic Parts Transfer	D (Black), DS (Black)	-	-	

⚠ For flat belt details, see **P.1279** onward.

⚠ In case of selecting Optional Belts, please select motor manufacturer A or B (Motor C is applicable for Standard Belt only).

Part Number	B	Body Price 1 ~ 2 pc(s).																	
		L415-450	L455-500	L505-600	L605-700	L705-800	L805-900	L905-1000	L1005-1100	L1105-1200	L1205-1300	L1305-1400	L1405-1500	L1505-1600	L1605-1700	L1705-1800	L1805-1900	L1905-2000	
CVSMA	60																		
	100																		
	150																		

⚠ For orders larger than indicated quantity, please check with WOS.

Motor Spec. Price	Motor Output	Specification	A (Panasonic Motor)	B (Oriental Motor)	R (No Motor, Gearhead)
	6W	IM	SCM		

Belt Spec. Price	Standard Belt	Optional Belt 1	Optional Belt 2	No Belt



Ordering Example: Part Number - B - L - Motor - Belt Specification - F - Motor Manufacturer Selection  
 CVSMA - 60 - 660 - 6 - TA230 - IM - 36 - H - F400 - A

Ex.) For No Belt  
 Ex.) For Optional Belt 2  
 Ex.) For No Motor, Gearhead

CVSMA-100-1000-6-TA230-SCM-25-J-F400-A  
 CVSMA-100-1000-6-TA230-SCM-25-GG-F400-B  
 CVSMA-100-1000-6-NV-NM-NH-H-F400-R

→ Body Price + Motor, Belt Spec. Price = Unit Price



Alterations: Brackets for Speed Controller Included  
 Post-Assembly Insertion Nuts Included  
 For details of alterations, see **P.1264** onward.