

Timing Belt Conveyors

Dual Track, Center Drive, 2-Groove Frame (Pulley Dia. 30mm)

■ **Features:** Since there are two rows of conveyor surfaces, sensors and stoppers can be mounted between the belts. The Center Drive configuration allows drive section position adjustments. With the addition of tapped holes for pulley holders, mounting of optional parts becomes easier, compared to CVSTN.



CVGTN

6W Motor Type

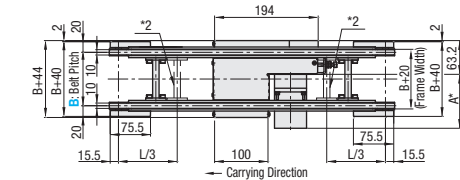

Frame Cross Section and Enlarged View (Symmetrical)

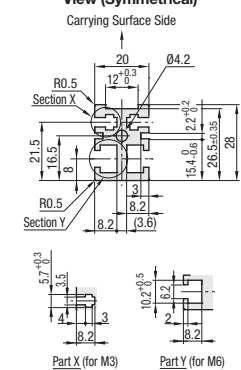

Compatible with JIS standard hex nuts.

	Frame	Motor Cover ①	Motor Cover ②	Pulley Holder
M Material	Aluminum	EN AW-5052 Plate	EN AW-5052 Plate	Aluminum
S Surface Treatment	Clear Anodize	Clear Anodize	Clear Anodize	Paint

■ Gearhead Reduction Ratio

*May decrease depending on load condition.

Gearhead Reduction Ratio	Belt Speed (m/min) 50Hz	60Hz
5	48.0	57.6
7.5	32.0	38.4
9	26.7	32.0
12.5	19.2	23.0
15	16.0	19.2
18	13.3	16.0
25	9.6	11.5
30	8.0	9.6
36	6.7	8.0
50	4.8	5.8
60	4.0	4.8
75	3.2	3.8
90	2.7	3.2
100	2.4	2.9
120	2.0	2.4
150	1.6	1.9
180	1.3	1.6

■ Conveying Capacity

* Reference Value

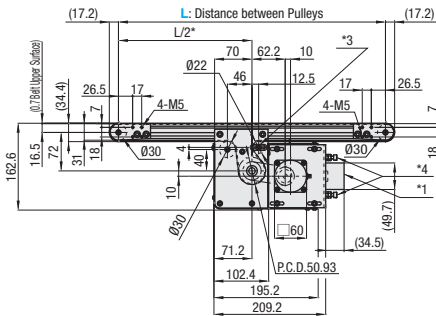
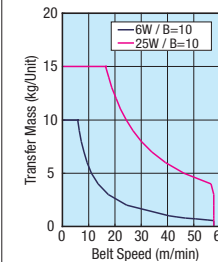

- * The drive section can be moved to a desired position within the aluminum extrusion slots.
- * When L≤365, each slot has 4 pre-inserted nuts provided.
- When counterbores for inserting nuts are required, please specify in alterations.

25W Motor Type

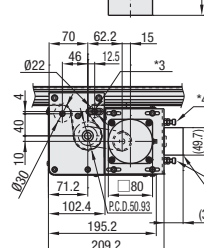
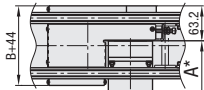

- Note
- *1 Capacitor: Installed on Single-Phase Induction Motors Only
- *2 When 2005≤L≤3000, Joints mounted at these locations (2 places)
- *3 M5 Screw for Tension
- *4 M6 Tensioning Screw

*Timing Belts used are T5 Type (P.1473, LTBRA-T5100-). See product pages for details.

* A Dimension Details

Output (W)	Motor Specification	Manufacturer	Reduction Ratio	A
6W	Induction Motor	Panasonic	12.5~25	101.0
		Oriental	30~180	108.0
	Variable Speed Motor	Panasonic	12.5~25	105.0
		Oriental	30~180	115.0
		Panasonic	12.5~25	111.0
		Oriental	30~180	118.0
25W	Induction Motor	Panasonic	12.5~25	111.0
		Oriental	30~180	118.0
	Variable Speed Motor	Panasonic	5~180	115.0
		Oriental	5~18	117.0
		Panasonic	25~180	127.5
		Oriental	25~180	137.5

Part Number	B 1mm Increment	L 5mm Increment	Output (W)	Voltage (V)	Motor Specification	Gearhead Reduction Ratio	Belt Specification	Motor Manufacturer Selection
CVGTN	80~300	265~3000	6 25	TA230 (Single-phase)	IM (Induction Motor) SCM (Variable Speed Motor)	5 7.5 9 12.5 15 18 25 30 36 50 60 75 90 100 120	S (For Sliding, Green) J (No Belt)	A (Panasonic Motor) B (Oriental Motor) R (No Motor, Gearhead)
			6 25	NV (No Motor)	NM (No Motor)	NH (No Gearhead)		
			6 25	NV (No Motor)	NM (No Motor)	NH (No Gearhead)		
			6 25	NV (No Motor)	NM (No Motor)	NH (No Gearhead)		

- Connect the motor so that the belt rotates in the direction of conveyance. For connection diagram, and details of motor and inverter, see P.1267 onward. For belt details, see P.1279 onward.
- When "No motor, gearhead" is selected, the motor mounting hole pitch will vary depending on the motor's power rating. Please see Technical Information in our Conveyor Selection web site for the dimension details.
- When "No motor, gearhead" is selected, this unit will be delivered unassembled. The customer is to assemble the unit according to the included assembly instructions. See our Conveyor Selection site for assembly procedures and packaging details.

Part Number	B	L265~300	L305~400	L405~500	L505~600	L605~700	L705~800	L805~900	L905~1000	L1005~1100	L1105~1200	L1205~1300	L1305~1400	L1405~1500	L1505~1600	L1605~1700	L1705~1800	L1805~1900	L1905~2000	L2005~2250	L2255~2500	L2505~2750	L2755~3000
CVGTN	80~100																						
	110~150																						
	160~200																						
	210~250																						
	260~300																						

For orders larger than indicated quantity, Days to Ship and Price are to be quoted.

Motor, Belt Spec. Price	Motor Output	Specification	A (Panasonic Motor)	B (Oriental Motor)	R (No Motor, Gearhead)	J (No Belt)
6W	25W	IM				
		SCM				

Ordering Example	Part Number	B	L	Motor	Output	Voltage	Specification	Gearhead Reduction Ratio	Belt Specification	Motor Manufacturer Selection
	CVGTN	90	980	6	TA230	SCM	15		S	A

Ex) For No Motor, Gearhead
Ex) For No Belt
CVGTN-100-1000-25-NV-NM-NH-S-R
CVGTN-100-1000-25-T100-IM-9-J-C
Body Price + Price with Motor + Belt Spec. Price = Unit Price

Alterations	Specify Drive Section Position	Additional Counterbores	Brackets for Speed Controller Included	Post-Assembly Insertion Nuts Included	Motors with Electromagnetic Brake	Motor with Terminal Box	Stands (Legs)

For details of alterations, see P.1264 onward.

Timing Belt Conveyors

Dual Track, Center Drive, 3-Groove Frame (Pulley Dia. 50mm)

■ **Features:** Since there are two rows of conveyor surfaces, sensors and stoppers can be mounted between the belts. The Center Drive configuration allows drive section position adjustments. With the addition of tapped holes for pulley holders, mounting of optional parts becomes easier, compared to CVSTP.



CVGTP

25W Motor Type

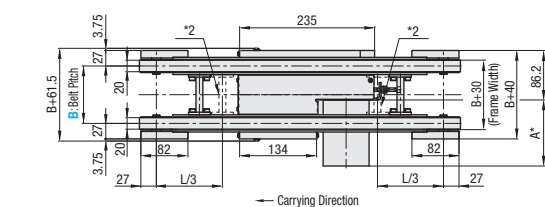

Frame Cross Section and Enlarged View (Symmetrical)

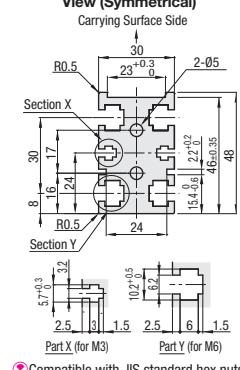

	Frame	Motor Cover ①	Motor Cover ②	Pulley Holder
M Material	Aluminum	EN AW-5052 Plate	EN AW-5052 Plate	Aluminum
S Surface Treatment	Clear Anodize	Clear Anodize	Clear Anodize	Paint

■ Gearhead Reduction Ratio

*May decrease depending on load condition.

Gearhead Reduction Ratio	Belt Speed (m/min) 50Hz	60Hz
5	48.0	57.6
7.5	32.0	38.4
9	26.7	32.0
12.5	19.2	23.0
15	16.0	19.2
18	13.3	16.0
25	9.6	11.5
30	8.0	9.6
36	6.7	8.0
50	4.8	5.8
60	4.0	4.8
75	3.2	3.8
90	2.7	3.2
100	2.4	2.9
120	2.0	2.4
150	1.6	1.9
180	1.3	1.6

■ Conveying Capacity

* Reference Value

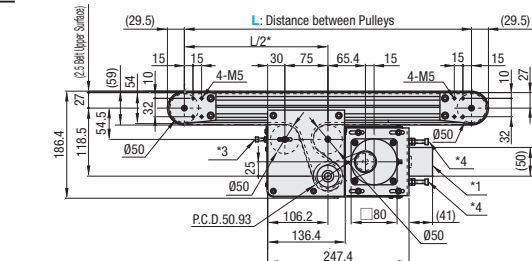
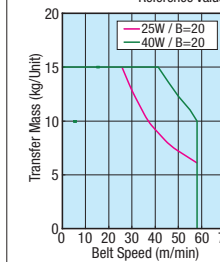

- * The drive section can be moved to a desired position within the aluminum extrusion slots.
- * When L≤425, each slot has 4 pre-inserted nuts provided.
- When counterbores for inserting nuts are required, please specify in alterations.

40W Motor Type

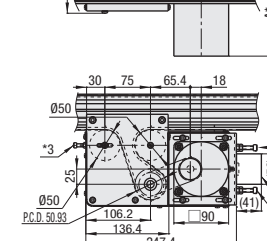

- Note
- *1 Capacitor: Installed on Single-Phase Induction Motors Only
- *2 When 2005≤L≤3000, Joints mounted at these locations (2 places)
- *3 M5 Screw for Tension
- *4 M6 Tensioning Screw

*Timing belts used is T10 Type (P.1473 LTBRA-T10200 onward). See product pages for details..

* A Dimension Details

Output (W)	Motor Specification	Manufacturer	Reduction Ratio	A
25W	Induction Motor	Panasonic	5~180	115.0
		Oriental	5~18	117.0
	Variable Speed Motor	Panasonic	25~180	127.5
		Oriental	5~18	127.0
		Panasonic	25~180	137.5
		Oriental	25~180	142.0
40W	Induction Motor	Panasonic	5~180	147.0
		Oriental	5~18	147.0
	Variable Speed Motor	Panasonic	25~180	152.0
		Oriental	5~18	157.0
		Panasonic	25~180	175.0
		Oriental	25~180	175.0

Part Number	B 1mm Increment	L 5mm Increment	Output (W)	Voltage (V)	Motor Specification	Gearhead Reduction Ratio	Belt Specification	Motor Manufacturer Selection
CVGTP	80~300	325~3000	25 40	TA230 (Single-phase)	IM (Induction Motor) SCM (Variable Speed Motor)	5 7.5 9 12.5 15 18 25 30 36 50 60 75 90 100 120	S (For Sliding, Green) J (No Belt)	A (Panasonic Motor) B (Oriental Motor) R (No Motor, Gearhead)
			25 40	NV (No Motor)	NM (No Motor)	NH (No Gearhead)		
			25 40	NV (No Motor)	NM (No Motor)	NH (No Gearhead)		
			25 40	NV (No Motor)	NM (No Motor)	NH (No Gearhead)		

- Connect the motor so that the belt rotates in the direction of conveyance. For connection diagram, and details of motor and inverter, see P.1267 onward. For belt details, see P.1279 onward.
- When "No motor, gearhead" is selected, the motor mounting hole pitch will vary depending on the motor's power rating. Please see Technical Information in our Conveyor Selection web site for the dimension details.
- When "No motor, gearhead" is selected, this unit will be delivered unassembled. The customer is to assemble the unit according to the included assembly instructions. See our Conveyor Selection site for assembly procedures and packaging details.

Part Number	B	L325~400	L405~500	L505~600	L605~700	L705~800	L805~900	L905~1000	L1005~1100	L1105~1200	L1205~1300	L1305~1400	L1405~1500	L1505~1600	L1605~1700	L1705~1800	L1805~1900	L1905~2000	L2005~2250	L2255~2500	L2505~2750	L2755~3000
CVGTP	80~100																					
	110~150																					
	160~200																					
	210~250																					
	260~300																					

For orders larger than indicated quantity, Days to Ship and Price are to be quoted.

Motor, Belt Spec. Price	Motor Output	Specification	A (Panasonic Motor)	B (Oriental Motor)	R (No Motor, Gearhead)	J (No Belt)
25W	40W	IM				
		SCM				

Ordering Example	Part Number	B	L	Motor	Output	Voltage	Specification	Gearhead Reduction Ratio	Belt Specification	Motor Manufacturer Selection
	CVGTP	130	660	25	TA230	IM	15		S	A

Ex) For No Motor, Gearhead
Ex) For No Belt
CVGTP-100-1000-25-NV-NM-NH-S-R
CVGTP-100-1000-25-T200-IM-18-J-B
Body Price + Price with Motor + Belt Spec. Price = Unit Price

Alterations	Specify Drive Section Position	Additional Counterbores	Brackets for Speed Controller Included	Post-Assembly Insertion Nuts Included	Motors with Electromagnetic Brake	Motor with Terminal Box	Stands (Legs)

For details of alterations, see P.1264 onward.