

Conveyor Chute / Angle Adjustment Bracket Single Article

Features: Chutes with their angle adjustable between 5 to 60 degrees. Plastic type is also available to make the workpiece move smoother and to prevent scratching of the workpiece.



Type	Material	Allowable Load (kgf)	Thickness (t)
Angle Adjustable	EN 1.4301 Equiv.	15	1.5
30° Angle-Fixed	EN 1.4301 Equiv. + Stainless Steel Sliding Plate*		1.5 + 0.8 (Sliding Plate Thickness)
	EN 1.4301 Equiv. + Ultrahigh molecular weight polyethylene		1.5 + 0.25 (Polyethylene Thickness)

* Use FENB0.5 (See P.1187)

Angle Adjustable CSHWS CSHWE CSHWU

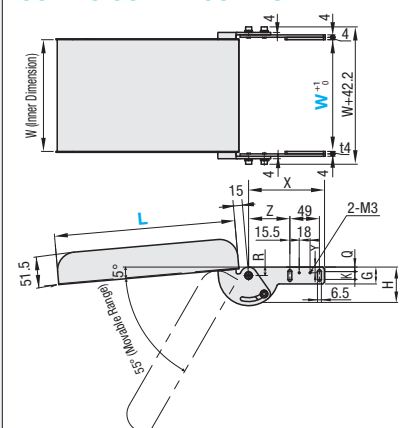

30° Angle-Fixed CSHYS CSHYE CSHYU

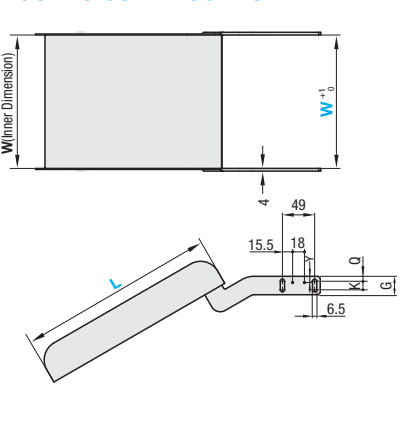

Applicable Conveyor Type	R	Z	X	K	Q	Y	G	H	Applicable Conveyors
A	14	68.5	126	13	9.5	7.5	28	57.1	SVKN/SVKR/CVGN/CVGP
B	14	98.5	156	13	9.5	7.5	28	57.1	CVGR/CVGW
C	24	83.5	141	30	10	10	48	75	CVSY/CV SX

- When L ≥ 310, we recommend the alteration YNS (Welding Nut + Leg).
- When mounting to MISUMI conveyors, the W dimensions should be: Belt Width + 40 for Bracket Type A, B; Belt Width + 50 for C.
- We will ship Angle Adjustable Types unassembled. Assembly will be required on your side. The 30° Angle-Fixed Types will be shipped assembled.
- M5/M6 Hex Socket Head Cap Screws and Washers are included for mounting of the conveyor. You will choose either of them and the rest will be left unused.

Angle Adjustable

Part Number	Applicable Conveyors Types	W 1mm Increment	L 10mm Increment	Applicable Conveyors	Conveyor Page
CSHWS	A	90-540		SVKN/SVKR/CVGN/CVGP	P1201-1204,1213-1216
CSHWE	B	90-340	70-500	CVGR/CVGW	P1217-1220
CSHWU	C	150-550		CVSY/CV SX	P1233-1236

30° Angle-Fixed

Part Number	Applicable Conveyors Types	W 1mm Increment	L 10mm Increment	Applicable Conveyors	Conveyor Page
CSHYS	A	90-540		SVKN/SVKR/CVGN/CVGP	P1201-1204,1213-1216
CSHYE	B	90-340	70-500	CVGR/CVGW	P1217-1220
CSHYU	C	150-550		CVSY/CV SX	P1233-1236

W	L	Unit Price				
		CSHWS	CSHWE	CSHWU	CSHYS	CSHYE
90-200	70-100					
	110-200					
	210-300					
	310-400					
201-300	110-200					
	210-300					
	310-400					
	410-500					
301-400	70-100					
	110-200					
	210-300					
	310-400					
401-550	70-100					
	110-200					
	210-300					
	310-400					

W is 150~ for the applicable conveyor type C.

Ordering Example: CSHWE - A - 150 - 300

For Adjusting Angle Bracket only

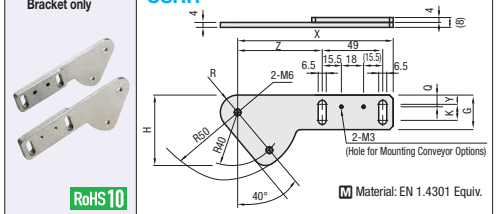

Left and right units together makes 1 set. Right and left units are symmetrical.

Dust Pans

Features: The pan receives fallout from the conveyor. Also compatible with liquid including oil.

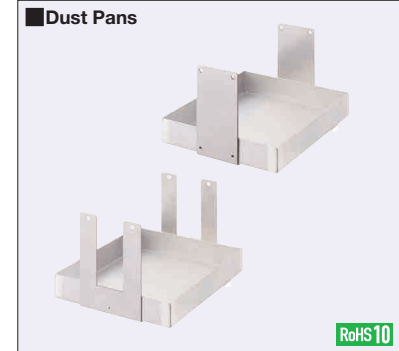

CDPT

Type	Material	Accessory
CDPT	EN 1.4301 Equiv.	Hex Socket Head Cap Screw (EN 1.4301 Equiv.) Washer (EN 1.4301 Equiv.)

When L ≤ 200

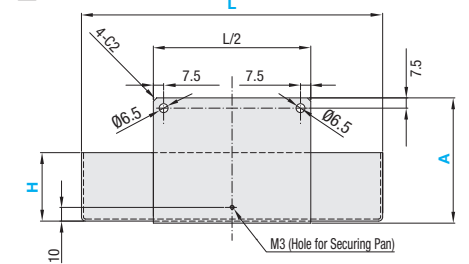

When L ≥ 205

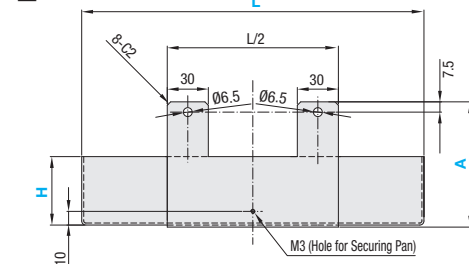

Also compatible with oil or water drops.

Part Number	W 1mm Increment	L 5mm Increment	H 10mm Increment	A 10mm Increment	Unit Price
CDPT	65-100	100-200	20-40	150-200	
		205-300			
		305-400			
	101-200	100-200			
		205-300			
		305-400			
	201-300	100-200			
		205-300			
		305-400			
	301-400	100-200			
		205-300			
		305-400			
401-550	100-200				
	205-300				
	305-400				

Ordering Example: CDPT - W - L - H - A

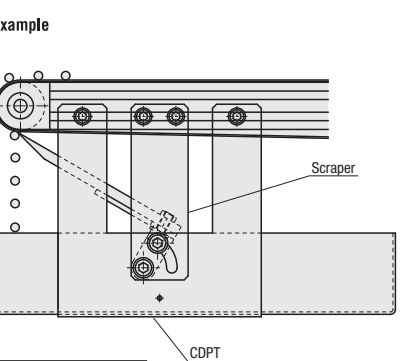

Alterations Example: CDPT - W - L - H - A - (CLU, CDL, CFN)

Alterations	Water/Oil Discharge Socket Welding	Handle Added	Pan Fixing Knob Added
Code	CLU, CLD, CRU, CRD	CDL	CFN
Spec.			Knurled Knob (M3) to secure the pan is included. Part Number: NOOS3-6 Specification: P.2-1078

