

Hinge / Slide Units for Fixtures / Bases

Horizontal, Vertical

Features: Units with vertically moving and sliding arms. Machine the arm section to use for workpiece shape measurements.
The rail and arm are pair engraved. Please use a rail and an arm as a set.

Hinge Units for Fixtures - Horizontal

(Alteration NB)

* The fulcrum pin is sold separately. **P907-**

RoHS 10

JHS (Rail & Arm Set)
JHSS (Joint Clearance of Rail and Arm 0 ~ 0.02, Sets)
JHR (Rail only)

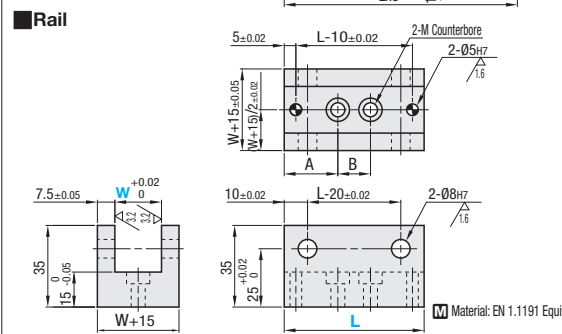
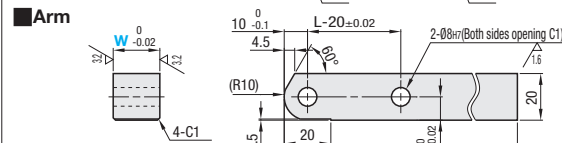
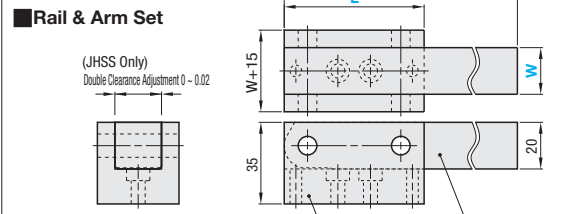

Slide Units for Fixtures

* Rail, lid and arm are not assembled before shipping.

RoHS 10

JSS (Rail & Arm Set)
JSSS (Joint Clearance of Rail and Arm 0 ~ 0.02, Sets)
JSR (Rail only)

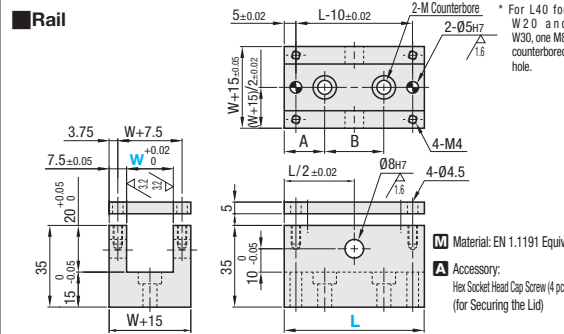
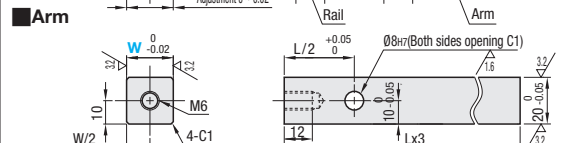
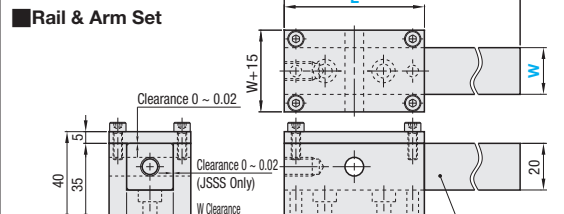

Hinge Units for Fixtures

Part Number	Type	W	L	Counterbored Hole Size M*	Counterbored Hole Position				Unit Price			
					A	B	m	Z	h	d	JHS	JHR
(Rail & Arm Set)		10		For M5								
JHS (Clearance 0 ~ 0.02)		20	60	For M6	23	14	M6	12.5	15	24		
JHSS (Rail only)		30										
JHR		50	80	For M8	26.5	27	M8	13.5	18	30		

Slide Units for Fixtures

Part Number	Type	W	L	Counterbored Hole Size M*	Counterbored Hole Position			Unit Price			
					A	B	G	F	E	JSS	JSR
(Rail & Arm Set)		10		M5, 2 places	L=40: A=13.75 B=12.5	L=60: A=20 B=20					
JSS (Clearance 0 ~ 0.02)		20	40	L=40: M8, 1 place	L=40: A=20 B=0						
JSSS (Rail only)		30	60	L=60: M6, 2 places	L=60: A=20 B=20						
JSR		50	80	M8, 2 places	A=26.5 B=27						

* For detailed sizes of the counterbore holes, refer to the Technical Data on P2296.

Hinge/Slide Unit Bases for Inspection

RoHS 10

Part Number	Type	A	B Selection	Applicable Hinge Unit	G	F	E	Unit Price
Hinge Unit Bases JHSP		100	65	JHS□10-60	18	32	50	
			75	JHS□20-60				
			85	JHS□30-60				
Slide Unit Bases JSSP		80	65	JSS□10-40	8.75	21.25	30	
			75	JSS□20-40				
			85	JSS□30-40	15	0		
		100	65	JSS□10-60	15	35	50	
			75	JSS□20-60				
			85	JSS□30-60				

Features: Units with vertically moving and sliding arms. Machine the arm section to use for workpiece shape measurements.

Hinge Units for Fixtures - Vertical

* The fulcrum pin is sold separately. **P907-**

RoHS 10

JHTS

Relief (Depth 0.5 - 2, Width W-20)
A-20±0.02
W+15
2-Ø8H7
2-Ø9
M8 Screw (Fall Prevention)
W+0.02
25±0.05
W±0.02
A/2
Lx3
25±0.05
A
15
20
15
L 0.02/100 X
M8x1.25
Ø8H7
R10
55
X

*Tolerance is applicable to dowel holes only.

Alphabets are engraved on the rail and arm.
Please use a rail and an arm as a set.

Material: EN 1.1191 Equiv.

Part Number	Type	W	L Selection	A	Unit Price
JHTS		30	60	100	
		50	80	120	

Ordering Example

Part Number	-	L	-	B
JHS20	-	60	-	
JSS20	-	40	-	
JHSP100	-	60	-	75
JHTS30	-	60	-	75

Alterations

Hinge Units for Fixtures - Horizontal / Slide Units for Fixtures	Part Number	-	L	-	(STC, NB, LC)
Hinge Units for Fixtures - Vertical	Part Number	-	L	-	(STC, LC, SYM)
	JHS20	-	60	-	NB
	JSS20	-	60	-	LC20

Alterations	Code	Spec.
Additional Surface Treatment (Black Oxide)	STC	Adds black oxide surface treatment.
Knob Bolt Set for Tightening and Fixing	NB	Instead of L pin hole, a knob-bolt is installed. A dedicated knob-bolt (Retained) is included. Applicable to W20, 30, 50 of JHS. Knob-bolt has retained structure. The Knob Bolt's threaded section retracts into the counterbore when the arm is lowered not damaging the rail.
Cuts L dimension of the arm.	LC	Cuts L dimension of the arm. Ordering Code LC20 (10mm Increment) 10 ≤ LC ≤ Lx2
Position of Bottom Face Mounting Hole	SYM	Positions the dowel hole and mounting hole symmetrically. Applicable to JHTS only.

Example

Machine the arm as required.

JHS (Alteration NB)
Horizontally Fixed (Standard)
Horizontally Fixed with Knob

JSS Embedded Bushing
KJLPSB Slide Units

JHTS Product Shape
Product
Hinge Unit