

Super Compact Strut Clamps / Resin Compact Strut Clamps

Equal / Unequal Dia., Perpendicular Configuration Equal Dia., Perpendicular Configuration

Super Compact Strut Clamps / Strut Clamps

Equal / Unequal Dia., Perpendicular Configuration with Wing Knobs Equal Dia., Perpendicular Configuration with Clamp Levers

■ Features: Affordable and compact Strut Clamps.

■ Super Compact Strut Clamps
Equal / Unequal Dia.,
Perpendicular Configuration

Type		Material	Surface Treatment	Accessory
Equal Dia.	Unequal Dia.			
ALKC	ALNC	Aluminum Alloy 6000 series	Black Anodize	Hex Socket Head Cap Screw
ALKW	ALNW		Clear Anodize	

Equal Dia., Perpendicular Configuration (ALKC, ALKW)

Unequal Dia., Perpendicular Configuration (ALNC, ALNW)

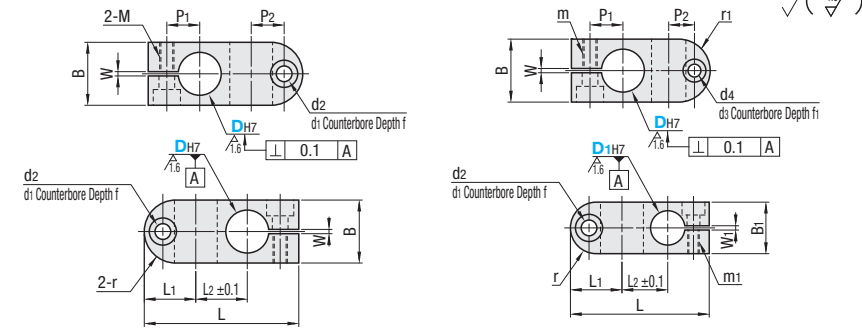

■ Equal Dia., Perpendicular Configuration

Part Number Type	DH7	B	L	L1	L2	r	P1	P2	m	Counterbored Hole			W	Unit Price ALKC, ALKW	
										d1	d2	f			
ALKC ALKW	6	+0.012/0	10	29	10.5	8	5	6.5	6.5	M3	6.5	3.5	3.5	1	
	8	+0.015/0	12	32	11	10	6	7	7						
	10	+0.018/0	16	39	13.5	12	8	8.5	8.5						
	12	+0.018/0	18	43	14	15	9	9	9	M4	8	4.5	4.5	1.5	
	15	+0.018/0	22	54	18	18	11	11.5	11.5	M5	9.5	5.5	5.5		

■ Unequal Dia., Perpendicular Configuration

Part Number Type	DH7	D1H7	B	B1	L	L1	L2	r	r1	P1	P2	m	Counterbored Hole			W	Unit Price ALNC, ALNW						
													d1	d2	f								
ALNC ALNW	8	+0.015/0	6	+0.012/0	12	10	31.5	11	10	5	6	7	6.5	M3	6.5	3.5	3.5	1					
	10	+0.015/0	6	+0.012/0	16	12	37.0	12	6	8	8.5	7	M4	8	4.5	4.5	1.5	M4	8	4.5	4.5	1	
																							36.5
	12	+0.018/0	8	+0.015/0	18	14	40.0	14	14	7	9	9	7.5	M4	8	4.5	4.5	1.5	M4	8	4.5	4.5	1
	15	+0.018/0	10	+0.015/0	22	18	49.0	18	16	9	11	11.5	9	M5	9.5	5.5	5.5	1.5	M5	9.5	5.5	5.5	1.5
48.5																							

⚠ The tolerance and perpendicularity of DH7 and D1H7 are the tolerances before slitting.
⚠ For mating, g6, f8 shaft tolerances are recommended. Tightening with a long wrench is recommended.

Ordering Example: Part Number - D1
ALKC8 - 8
ALNC10 - 8

Included Screw: Equal Dia., Perpendicular Configuration				Included Screw: Unequal Dia., Perpendicular Configuration			
D	D1	Included Screw	Quantity	D	D1	Included Screw	Quantity
6	6	M3-6	2 pcs.	8	6	M3-6, M3-8	1 pc. each
8	8	M3-8		10	8	M4-6, M4-10	
10	10	M4-10		12	10	M3-8, M4-10	
12	12	M4-12		12	10	M4-8, M4-12	
15	15	M5-15		12	10	M3-10, M4-12	
				15	10	M5-12, M5-15	
				15	12	M4-12, M5-15	

■ Features: Affordable Strut Clamps when purchased 10 pcs. or more. Suitable for applications where many are needed, such as for Conveyers, etc. ⚠ For clamps in stand sets for mounting sensors, refer to P2057, 2058

■ Resin Compact Strut Clamps
Equal Dia., Perpendicular
Configuration

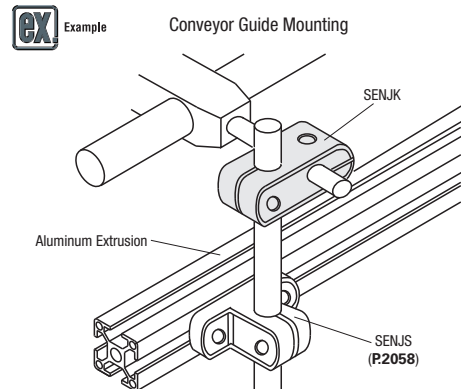
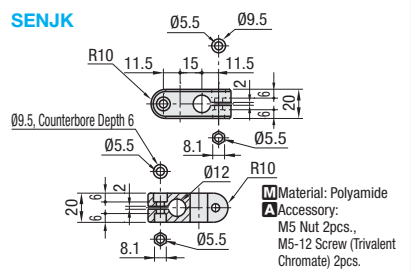

⚠ Resin clamps are not suitable for supporting heavy objects.

Ordering Example: Part Number
SENJK

Part Number	Unit Price	Volume Discount Rate
SENJK	1 ~ 9 pc(s)	10 ~ 50 pcs.

⚠ For orders larger than indicated quantity, please check with WOS.

■ Features: Affordable and compact Strut Clamps. Easy setup changes with wing knobs.

■ Equal / Unequal Dia., Perpendicular
Configuration with Wing Knobs

Type		Material	Surface Treatment	Accessory
Equal Dia.	Unequal Dia.			
ALKCC	ALNCC	EN AW-6061 Equiv.	Black Anodize	Wing Knob (Black) Wing Knob (White)
ALKWC	ALNWC		Clear Anodize	

* Head of Wing Knob: Nylon 66
Thread Section: SWRM-10
Trivalent Chromate

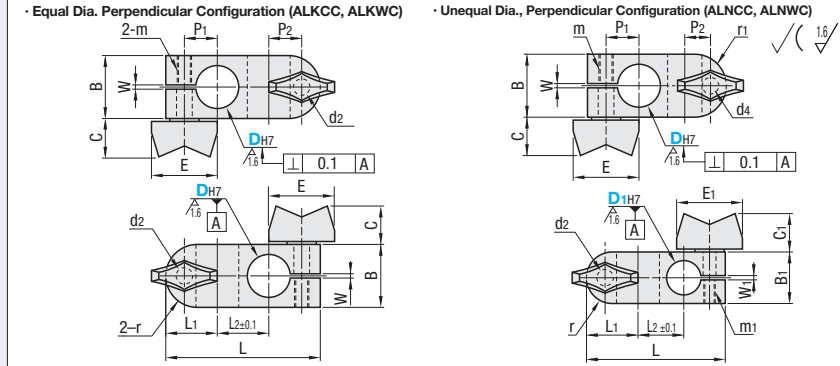

■ Equal Dia., Perpendicular Configuration with Wing Knobs

Part Number Type	DH7	B	L	L1	L2	r	P1	P2	d2	m	W	Wing Knob		Unit Price ALKCC, ALKWC
												E	C	
ALKCC ALKWC	6	+0.012/0	10	29	10.5	8	5	6.5	6.5	3.5	M3	1		
	8	+0.015/0	12	32	11	10	6	7	7			18	10.5	
	10	+0.018/0	16	39	13.5	12	8	8.5	8.5	4.5	M4	1.5		
	12	+0.018/0	18	43	14	15	9	9	9	5.5	M5		28	15
	15	+0.018/0	22	54	18	18	11	11.5	11.5					

■ Unequal Dia., Perpendicular Configuration with Wing Knobs

Part Number Type	DH7	D1H7	B	B1	L	L1	L2	r	r1	P1	P2	d4	m	W	Wing Knob		Unit Price ALNCC, ALNWC					
															E1	C1						
ALNCC ALNWC	8	+0.015/0	6	+0.012/0	12	10	31.5	11	10	5	6	7	6.5	3.5	M3	1	18	10.5				
	10	+0.015/0	6	+0.012/0	16	12	37	12	6	8	8.5	7	4.5	M4	1.5	18	10.5	M3	1	18	10.5	
																						36.5
	12	+0.018/0	8	+0.015/0	18	14	40	14	14	7	9	9	7.5	4.5	M4	1.5	18	10.5	M4	1	18	10.5
	15	+0.018/0	10	+0.015/0	22	18	49	18	16	9	11	11.5	9	5.5	M5	1.5	28	15	M5	1.5	28	15
48.5																						

⚠ The tolerance and perpendicularity of DH7 and D1H7 are the tolerances before slitting.
⚠ For mating, g6, f8 shaft tolerances are recommended. ⚠ Do not tighten the wing nut unless the shaft is set in D part.

Ordering Example: Part Number - D1
ALKCC8 - 8
ALNCC10 - 8

■ Features: Easy setup changes, suitable for frequent changes.

■ Equal Dia., Perpendicular Configuration
with Clamp Levers

Type	Material	Surface Treatment	Accessory
KKST	EN 1.0038	Black Oxide	Clamp Lever
MKST	Equiv.	Electroless Nickel Plating	
AKST	EN AW-6063 Equiv.	Black Anodize	
SKSTS	EN 1.4301 Equiv.	-	

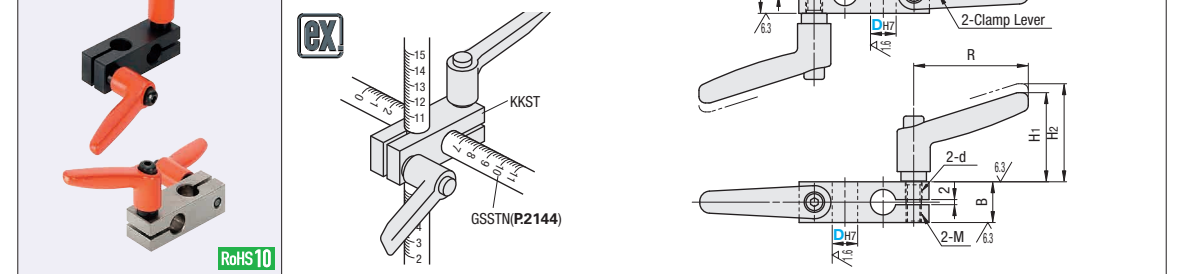

Part Number Type	DH7	A	B	E	F	H	M	d	R	H1	H2	Clamp Lever	Unit Price			
													KKST	MKST	AKST	SKSTS
KKST MKST AKST (D≤30) SKSTS (D≤30)	10	+0.015/0	51	16	18	15	12	M6	6.6	45	38.5	CLDM 6-16-M				
	12	+0.018/0	54	19	18	18	12	M6	9	63	45.5	49	CLDM 6-20-M			
													CLDM 8-20-M			
	20	+0.021/0	78	28	26	26	19	M10	11	78	55	59	CLDM 8-25-M			
													CLDM 10-32-M			
	30	+0.025/0	105	40	34	37	25	M12	13	92	67	71	CLDM 10-40-M			
													CLDM 12-40-M			

⚠ Available D Dimension for AKST and SKSTS is up to 30. ⚠ The tolerance and perpendicularity of DH7 are before slitting. ⚠ For mating, g6, f8 shaft tolerances are recommended.

Ordering Example: Part Number
KKST20
SKSTS15