

# Strut Clamps

Equal / Unequal Dia., Rotation

■ Features: Angle adjustments are possible between posts

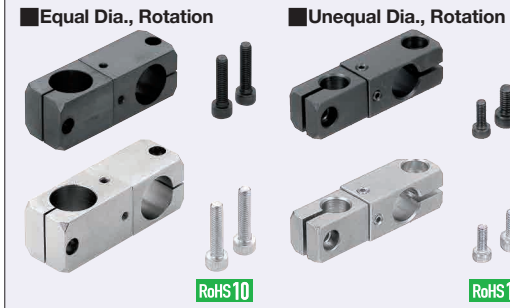

Type		Material	Surface Treatment	Accessory
Equal Dia., Rotation	Unequal Dia., Rotation			
<b>KLSR</b>	<b>KDSR</b>	EN 1.0038 Equiv.	Black Oxide	Hex Socket Head Set Screw
<b>MLKR</b>	<b>MDKR</b>			
<b>ALKR</b>	<b>ADKR</b>	EN AW-6063 Equiv.	Electroless Nickel Plating	Hex Socket Head Set Screw
<b>SLKR</b>	<b>SDKR</b>	EN 1.4301 Equiv.	Black Anodize	

⚠ Accessory: CB screws (P2-171) and MSSK (P2-210) are included with black oxide/black anodized products, and SCB screws (P2-173) and MSSU (P2-210) are included with the other products, respectively.

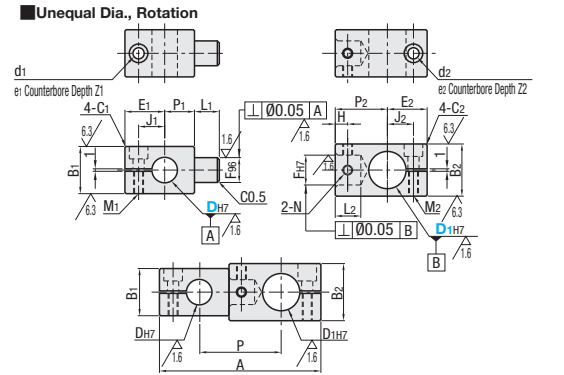
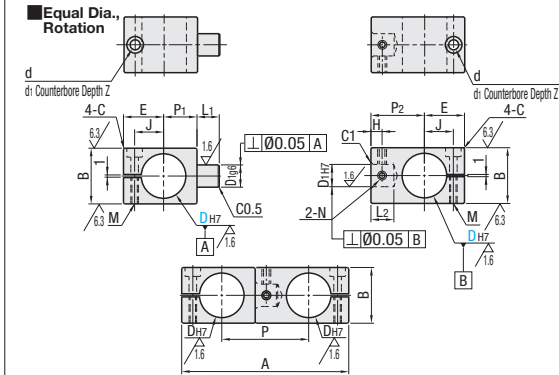

■ Equal Dia., Rotation

Part Number		D1	g6	H7	A	B	P	P1	P2	L1	L2	E	H	J	M	N	d	d1	Z	C
Type	DH7																			
<b>KLSR</b>	8	5	-0.004	+0.012	42	12	19	7	12	6	6.3	11.5	3	7	M3	M3	3.5	6.0	3	2
	10				51	13	23	9	14											
<b>MLKR</b>	12	10	-0.005	+0.015	57	15	26	11	15	10	10.3	16.0	5	10.5	M4	M4	4.5	7.5	5	3
<b>ALKR</b>	15				65	19	33	12	21											
<b>SLKR</b>	20	10	-0.014	0	76	25	39	15	24	10	10.3	22.0	5	16	M5	M5	5.5	9.0	5.5	4
	25				88	30	44	18	26											

⚠ The tolerance and perpendicularity of DH7 are before slitting.

⚠ For mating, g6, f8 shaft tolerances are recommended. Tightening with a long wrench is recommended.

■ Unequal Dia., Rotation

Part Number		D1H7	F	g6	H7	A	B1	B2	P	P1	P2	L1	L2	E1	E2	H	J1	J2	M1	M2	N	d1	d2	e1	e2	Z1	Z2	C1	C2
Type	DH7																												
<b>KDSR</b>	8	5	-0.004	+0.012	46.5	12	13	21	7	14	6	6.3	11.5	14	3	7	9	M3	M4	M3	3.5	4.5	6	7.5	3	5	2	2	
	10				49	12	15	22	7	15																			11.5
<b>MDKR</b>	12	10	-0.005	+0.015	53.5	13	15	24	9	15	10	10.3	16	18.5	10.5	13	M4	M4	M4	4.5	4.5	7.5	7.5	5	5	3	3		
<b>ADKR</b>	15				70.5	19	25	36	12	24																		10.5	16
<b>SDKR</b>	20	10	-0.014	0	81.5	25	30	41	15	26	10	10.3	18.5	22	13	16	M4	M5	M5	4.5	5.5	7.5	9	5	5.5	3	4		
	25				81.5	25	30	41	15	26																		18.5	22

⚠ The tolerance and perpendicularity of DH7 and D1H7 are the tolerances before slitting. ⚠ For the available sizes, refer to the price list.

⚠ For mating, g6, f8 shaft tolerances are recommended. Tightening with a long wrench is recommended.

Ordering Example: Part Number - D1  
MLKR10 - 12  
KDSR8 - 12

■ Equal Dia., Rotation

D	Unit Price			
	KLSR	MLKR	ALKR	SLKR
8				
10				
12				
15				
20				
25				

■ Unequal Dia., Rotation

D-D1	Unit Price			
	KDSR	MDKR	ADKR	SDKR
8-10				
8-12				
10-12				
15-20				
15-25				
20-25				

■ Included Screw

D	Included Screw	
	Equal Dia., Rotation	Unequal Dia., Rotation
8	M3-8, 2 pcs.	M3-8/M4-8, 1 pc. each
10	M4-8, 2 pcs.	M3-8/M4-10, 1 pc. each
12	M4-10, 2 pcs.	M4-8/M4-10, 1 pc. each
15	M4-12, 2 pcs.	M4-12/M4-20, 1 pc. each
20	M4-20, 2 pcs.	M4-12/M5-20, 1 pc. each
25	M5-20, 2 pcs.	M4-20/M5-20, 1 pc. each

# Strut Clamps

Square / Round Hole, Rotation

■ Features: Combined with Square Tubes and Stand-Up Brackets, Strut Clamps can prevent rotation while adjusting height.

■ Square / Round Hole, Rotation

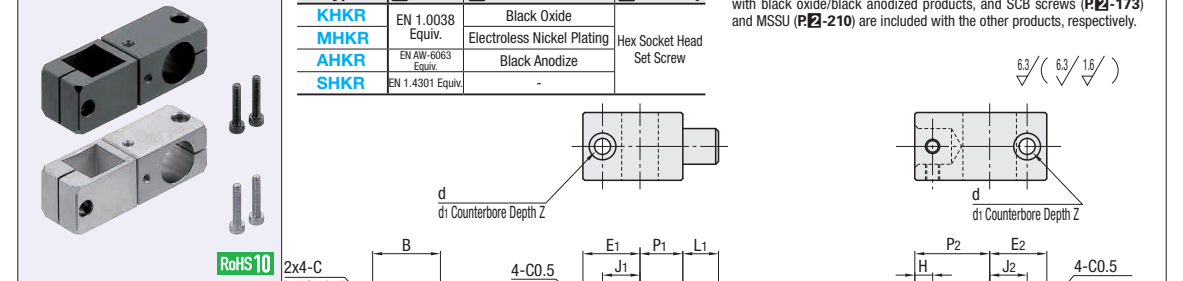

Type	Material	Surface Treatment	Accessory
<b>KHKR</b>	EN 1.0038 Equiv.	Black Oxide	Hex Socket Head Set Screw
<b>MHKR</b>	EN AW-6063 Equiv.	Electroless Nickel Plating	
<b>AHKR</b>	EN AW-6063 Equiv.	Black Anodize	Hex Socket Head Set Screw
<b>SHKR</b>	EN 1.4301 Equiv.	-	

⚠ Accessory: CB screws (P2-171) and MSSK (P2-210) are included with black oxide/black anodized products, and SCB screws (P2-173) and MSSU (P2-210) are included with the other products, respectively.

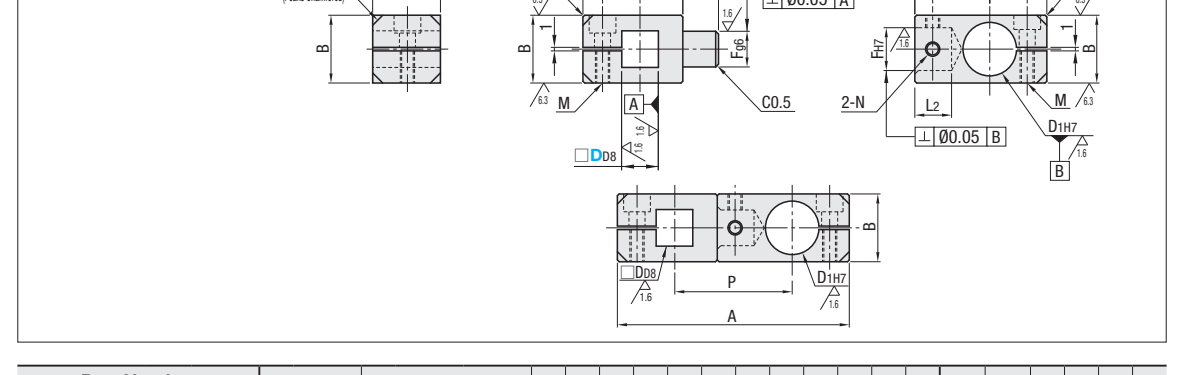

Part Number		D1H7*	F	g6	H7	A	B	P	P1	P2	L1	L2	E1	E2	H	J1	J2	M (Coarse)	N (Coarse)	d	d1	Z	C
Type	DD8*																						
<b>KHKR</b>	8	5	-0.004	+0.012	43	12	19	7	12	6	6.3	12.5	11.5	3	8	7	M3	M3	3.5	6	3	2	
	10				52	13	23	9	14														15
<b>MHKR</b>	12	10	-0.005	+0.015	58	15	26	11	15	10	10.3	16.5	15.5	5	12.5	10.5	M4	M4	4.5	7.5	5	3	
<b>AHKR</b>	15				67	19	33	12	21														18
<b>SHKR</b>	20	10	-0.014	0	78	25	39	15	24	10	10.3	20.5	18.5	5	18	16	M5	M5	5.5	9	5.5	4	
	25				90	30	44	18	26														24

\* The tolerance and perpendicularity of DD8 and D1H7 are the tolerances before slitting.

⚠ For mating, g6, f8 shaft tolerances of D1 are recommended. Tightening with a long wrench is recommended.

Ordering Example: Part Number  
KHKR20

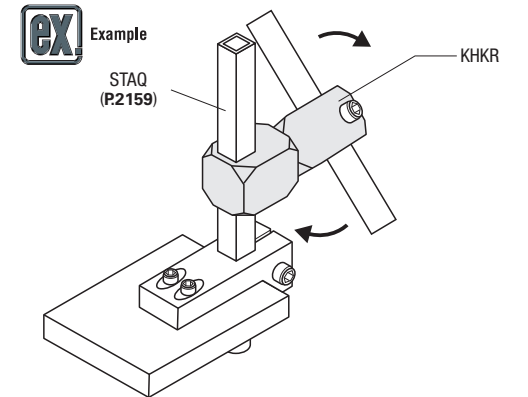

D	Unit Price			
	KHKR	MHKR	AHKR	SHKR
8				
10				
12				
15				
20				
25				

■ Included Screw

D	Included Screw
8	M3-8, 2 pcs.
10	M4-8, 2 pcs.
12	M4-10, 2 pcs.
15	M4-12, 2 pcs.
20	M4-20, 2 pcs.
25	M5-20, 2 pcs.