

Thin Brackets

For 5 Series (Slot Width 6mm) Aluminum Extrusions

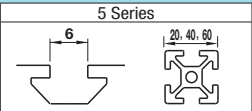

■Features: Thin Extruded Brackets with space saving design.

Thin Brackets



Type	Material	Surface Treatment
HBLSS5	EN AC-51400-T5	Clear Anodize
HBLSSB5	Equiv.	Black Anodize

HBLSS5
HBLSSB5
(Black Anodize)

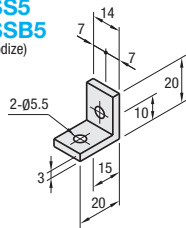

HBLSD5
HBLSDB5
(Black Anodize)

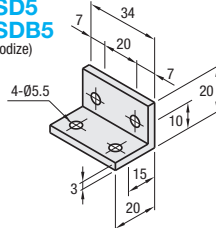

HBLST5

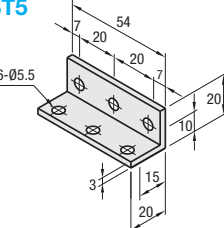

Part Number Type	Mass (g)	Applicable Screw	T Nut	Allowable Load (N)	Unit Price (1-99 pc(s))	Volume Discount Rate
HBLSS5	3.8	CBM5-8	HNTT5-5	2	686	
HBLSSB5* (Black Anodize)						
HBLSD5	10	CBM5-8	HNTT5-5	4	1176	
HBLSDB5* (Black Anodize)						
HBLST5	15			6	1617	

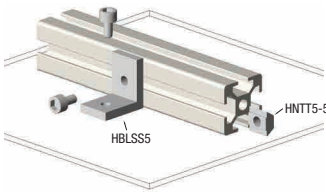

* For repairing black anodizing, refer to P.846.

■Features: Thin Brackets with tabs to fit in slots of extrusions and stop rotating when tightening.

Thin Stainless Steel Tabbed Brackets



HBLSP5

Material: EN 1.4301 Equiv.

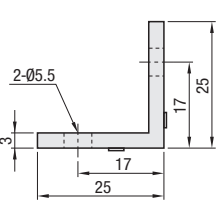
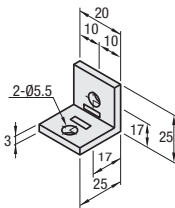

Type	Mass (g)	Applicable Screw	T Nut	Allowable Load (N)	Unit Price (1-99 pc(s))	Volume Discount Rate
HBLSP5	10	CBM5-8	HNTT5-5	2	686	



■Features of HBLSP (Slot Stainless Steel Brackets with Tabs)

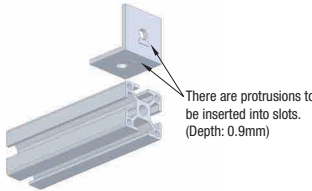

Ordering Example
Part Number
HBLST5



Part Number
HBLST5 - SET

Alterations	Code	Spec.	Applicable Bracket
Applicable Screws and Nuts Set	SET	Applicable screws and nuts for fixing the brackets on extrusions come in a set. (Adds to the bracket price.)	
	SST	(Ex.) When HBLSS5 is specified:	
	SEU	CODE Screw Nut	
	SSU	SET CBM5-8 HNTT5-5	HBLSS5
	SEP	SST SCB5-8 HNTTBS5-5	HBLSSB5
	SSP	SEU CBM5-8 HNTTUS-5	HBLSD5
		SSU SCB5-8 SHNTUS-5	HBLSDB5
		SEP CBM5-8 HNTTP5-5	HBLST5
		SSP SCB5-8 SHNTTP5-5	HBLST5
		When specifying other than HBLSS5, check for the applicable screws and nuts.	HBLSP5

⚡ Screws for black anodized brackets are HCBMTB (Trivalent Chromate Black) on P.751.
⚡ Included Screw is not RoHS compliant when -SET, -SEU or -SEP other than black anodized brackets is specified.

Plate Brackets / Block Brackets

For 5 Series (Slot Width 6mm) Aluminum Extrusions

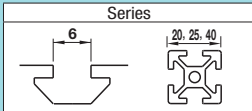

■Features: Direct screw-on brackets to use on tapped extrusions.

Plate Brackets

HBLPL5-4040

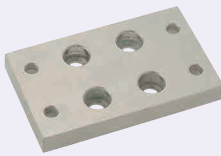

Material : EN 1.0038 Equiv.
Surface Treatment: Electroless Nickel Plating

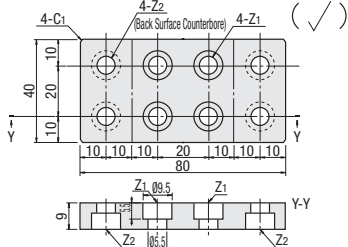

Part Number Type	Extrusion	Z1 Applicable Screw	Z2 Applicable Screw	Mass (g)	Unit Price (1 ~ 9 pc(s))	Volume Discount Rate
HBLPL5	4040	M5	M5	210		

Ordering Example
Part Number
HBLPL5 - Extrusion
4040



Alterations
Part Number
HBLPL5 - Extrusion - (DC)
4040 - DC10

Alteration	Code	Spec.
Through Hole	DC	Adds a through hole. DC=Hole Dia. 1 mm Increment 10≤DC≤20 Ordering Code DC12

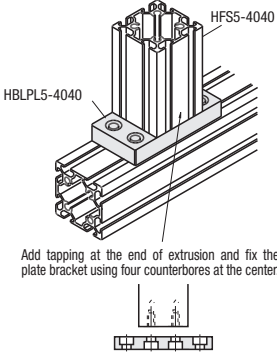

■Features: The brackets do not protrude from extrusion widths when used to cross connect extrusions. Space-saving design compared to Tabbed Reversal Brackets.

Block Brackets

HBLBL5



Material : EN AW-6063 Equiv.
Surface Treatment: Anodize

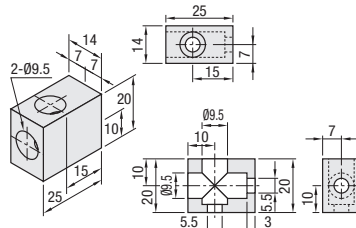

Part Number Type	Mass (g)	Applicable Screw	Allowable Load (N)	Unit Price (1-99 pc(s))	Volume Discount Rate
HBLBL5	13	CBM5-8	2	686	

Ordering Example
Part Number
HBLBL5



Alterations
Part Number
HBLBL5 - (SET, SST, SEU, SSU, SEP, SSP)
SET

Alterations	Code	Spec.	Applicable Bracket
Applicable Screws and Nuts Set	SET	Applicable screws and nuts for fixing the brackets on extrusions come in a set. (Adds to the bracket price.)	
	SST	CODE Included Screw Included Nut	
	SEU	SET CBM5-8 HNTT5-5	
	SSU	SST SCB5-8 HNTTBS5-5	
	SEP	SEU CBM5-8 HNTTUS-5	
	SSP	SSU SCB5-8 SHNTUS-5	
		SEP CBM5-8 HNTTP5-5	
		SSP SCB5-8 SHNTTP5-5	
			HBLBL5

⚡ Included Screw is not RoHS compliant when -SET, -SEU or -SEP are specified.