

Rolled Ball Screws Standard Nut - Shaft Dia. 12; Lead 4, 5, 10  
Accuracy Grade C7, C10

Part Number  
& Spec.Change  
Printed in Purple



Points of comparison  
between similar products

- Due to the difference in load rating and positioning accuracy (lead accuracy + axial play), the price is lower than that of similar products.
- When considering adopting C-VALUE parts, select them by comparing against similar products in the specifications. P. 701 ~ P. 702

Similar Product Pages P. 701 - P. 702

Nut Type	Type		Accuracy Grade	Shaft Dia.	Lead	Screw Shaft			Nut		
	Standard	F, P Configurable				Material	Hardness	Surface Treatment	Material	Hardness	Surface Treatment
Standard Nut	C-BSST	C-BSSTK	C7	12	4	EN 1.1203 Equiv.	Induction Hardened 58 to 62 HRC	-	EN 1.7242 Equiv.	Carburized 58 to 62 HRC	-
	C-BSSC	C-BSSCK	C10								
	C-BSSTA	C-BSSTAK	C7								
	C-BSSCA	C-BSSCAK	C10								

C-BSST(K), C-BSSC(K)1204

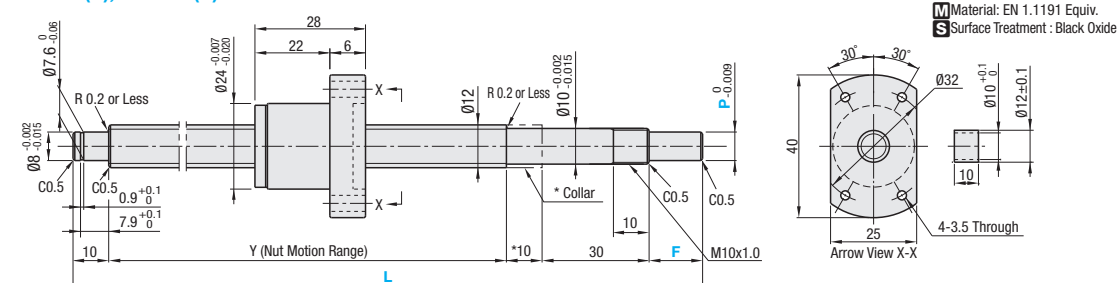

C-BSSTA(K), C-BSSCA(K)1205

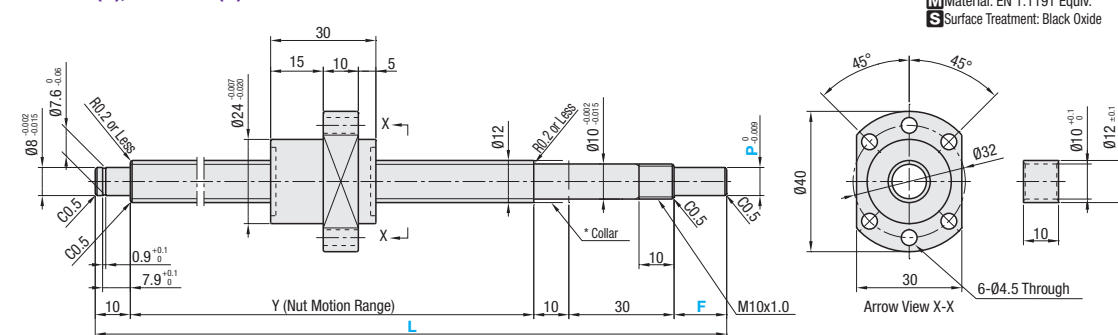

C-BSSTA(K), C-BSSCA(K)1210

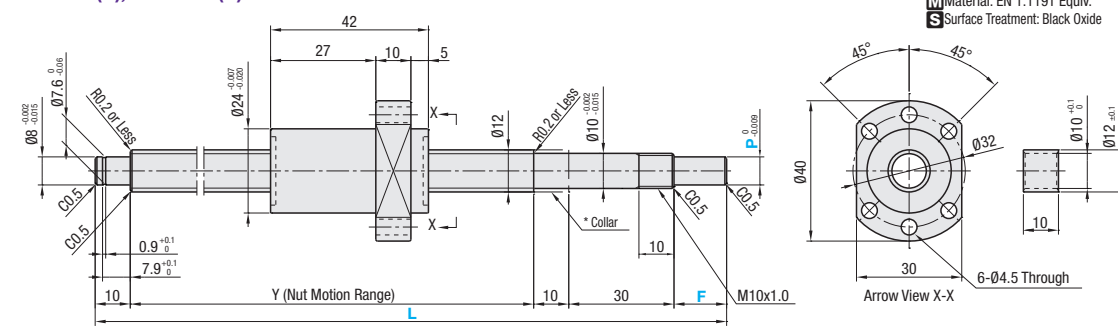

Nut Type	Accuracy Grade	Part Number			1 mm Increments			Y	Ball Dia.	Ball Center Dia.	Screw Root Dia.	Number of Circuits	Basic Load Rating		Axial Play	Twisting Direction
		Type	Screw Shaft O.D.	Lead	L	*F	*P						C (Dynamic) kN	Co (Static) kN		
Standard Nut	C7	C-BSST	12	4	150~800	15	8	L - 65	2.5	12.7	(10.2)	1 turn 3 rows	1.8	4.1	0.05 or less	Right
		C-BSSTK				15~24	5~8	L - (50 + F)								
	C10	C-BSSC				15	8	L - 65								
		C-BSSCK				15~24	5~8	L - (50 + F)								
	C7	C-BSSTA				15	8	L - 65								
		C-BSSTAK				15~24	5~8	L - (50 + F)								
	C10	C-BSSCA	15	8		L - 65										
		C-BSSCAK	15~24	5~8		L - (50 + F)										
	C7	C-BSSTA	15	8		L - 65										
		C-BSSTAK	15~24	5~8		L - (50 + F)										
	C10	C-BSSCA	15	8		L - 65										
		C-BSSCAK	15~24	5~8		L - (50 + F)										

\*F and P are configurable for C-BSSTK, C-BSSCK, C-BSSTAK and C-BSSCAK only. \*F ≤ P × 3 \*Y (Nut Motion Range) > (Nut Overall Length) kgf = N × 0.101972

Nut Type	Accuracy Grade	Part Number	JPY Unit Price: 1 to 4 pc(s).		
			L150-400	L401-600	L601-800
Standard Nut	C7	C-BSST1204			
	C10	C-BSSC1204			
	C7	C-BSSTA1205			
	C10	C-BSSCA1205			
	C7	C-BSSTA1210			
	C10	C-BSSCA1210			



Ordering  
Example

Part Number	-	L	-	F	-	P
C-BSSCA1205	-	600				
C-BSSCAK1205	-	1284	-	F20	-	P8

Notes

- Filled with lithium soap based grease (Alvania Grease S2 made by Showa Shell Sekiyu K.K.).
- For accuracy of Ball Screws, see P. 2223 and P. 2224.
- For details of Support Units, see P. 753 to P. 778.
- Cautions: Do not let the nuts overrun or remove the nuts from the screw shafts. It may cause the balls to fall out or damage the ball recirculation parts.
- The collar included with this product should be installed in the same position as indicated on the drawing by "Collar." The collar included with the Support Unit product should be installed and tightened on the nut side of the ball screw.
- Note that, when a ball screw shaft or ball screw nut is tilted, it may fall out due to its own weight.



Alterations

Part Number	-	L	-	F	-	P	-	(FC, KC...etc.)
C-BSSCA1205	-	270						SC7

Alterations	Code	Spec.
No Machining on Both Shaft Ends (Annealing Range) 4-C Nut Temp Shaft	WNC	Does not machine any of the both shaft ends. [Ordering Code] WNC-S20-F80 * Annealing may lower hardness on the annealed area + 25 mm fore and aft. * S + F ≤ L/2 * L - (S + F) ≤ Y + 50 * On the annealed area + 25 mm fore and aft, axis run-out may be larger than indicated by the catalog standard.
No Machining on Support Side Shaft End	NC	No machining added on the support side shaft end. [Ordering Code] NC
Ball Nut Orientation Reversed (Support Side) (Fixed Side) Change	RLC	Changes the nut direction. [Ordering Code] RLC
No Retaining Ring Groove on Support Side Shaft End	RNC	No retaining ring groove is machined on the support side shaft end. [Ordering Code] RNC * Combination with FC is not available.
Change Support Side Shaft End Machining	GC	Changes the machining on the support side. Q is selectable from 10, 12 or 15. G = 1 mm Increments [Ordering Code] GC - Q10 - G20 * 5 ≤ Q ≤ Q × 3 * Y dimension is shortened. * No Retaining Ring Groove * Combination with FC is not available.
Change Support Side Shaft End Length	FC	Changes the length of the support side shaft end. FC = 1 mm Increments [Ordering Code] FC20 * 13 ≤ FC ≤ 30 * Y dimension is shortened. * Combination with GC is not available.
Tapped Hole on Support Side Shaft End	MC	Adds a tapped hole on the support side shaft end. MC = 1 mm Increments [Ordering Code] MC25 M L M6 x 1.0 15 * 21 ≤ MC ≤ 30 * Y dimension is shortened.

Alterations	Code	Spec.
Wrench Flats on Fixed Side 16-0.25	SZC	Adds wrench flats on the fixed side shaft end. [Ordering Code] SZC * Ball bearings will fall out if the ball nut crosses the wrench flats.
Keyway on Fixed Side Shaft End Detailed Keyway Dimensions P. 684	KC	Adds a keyway on the fixed side shaft end. KC = 1 mm Increments [Ordering Code] KC15 * 4 ≤ KC ≤ P × 3, KC ≤ F - 1
Keyway on Fixed Side Shaft End K S	KLC	Adds a keyway at a customer specified area on the fixed side shaft end. (Keyway dim. is same as that of KC.) K, S = 1 mm Increments [Ordering Code] KLC - K7 - S2 * 5 ≤ K + S ≤ P × 3, K + S ≤ F - 1
Flat Machined on Fixed Side Shaft End SC 0.5	SC	Adds a flat on the fixed side shaft end. SC = 1 mm Increments [Ordering Code] SC7 * 5 ≤ SC ≤ P × 3, SC ≤ F - 1
2 Flats Machined on Fixed Side Shaft End SWC SGC 0.5 0.5	SWC SGC	Adds two flats on the fixed side shaft end. SWC: 90° Position, SGC: 120° Position 1 mm Increments [Ordering Code] SWC10 * 5 ≤ SWC/SGC ≤ P × 3, SWC/SGC ≤ F - 1
Installing Special Temporary Shaft Temporary Shaft Nut Screw Shaft	TAS	Special Temporary Shafts suitable with Ball Screws are installed. When removing Nut from Screw Shaft, always use Special Temporary Shaft. * For installation method, see P. 685.

Combination with Support Units

Ball Screw Part Number			Recommended Support Unit			
Type	Screw Shaft O.D.	Lead	Part Number Type No.	Shape	Fixed Side	Support Side Page
C-BSSC C-BSSCA C-BSSTH	12	04 05 10	C-BSSW 10S	Square	○	P. 763
			C-BUN 10		○	P. 764
			C-BRW 10S	Round	○	P. 769
			C-BUR 10		○	P. 770

- Other than the part numbers shown above, a rich variety of Support Units are also available. (P. 761 - P. 780)
- Nut Brackets for C-Value Ball Screws are not available.

