

# Miniature Linear Guides-Lubrication Units-

## -Standard Block · Interchangeable, Slight Clearance-

Linear Guide Related Products			
Position-keeping Parts	Rails Height Adjusting Blocks	Blocks Fall-off Prevention Parts Dust Resistant Parts	Blocks / Rails Fixing Parts
P581~ P588			

CAD Data

**Features:** Blocks with Lubrication Units provide long term maintenance-free condition.



Material Hardness	Rail Width	Type			L Dimension	Block Specifications
		Sets	Blocks	Rails		
Stainless Steel (1.4125/ X105CrMo17) 56-60HRC	Standard Rails	SAUS	SAU	SAUL	Selectable	-
		SAUPS	SAUP	-	-	With Lubrication Unit
		SAUSL	SAU	SAULF	Specified	-
	Wide Rails	SAUPS	SAUP	-	-	With Lubrication Unit
		SAWS	SAW	SAWL	Selectable	-
		SAWSL	SAWP	SAWLF	Specified	With Lubrication Unit

Heat Resistant Temperature: -20~80°C

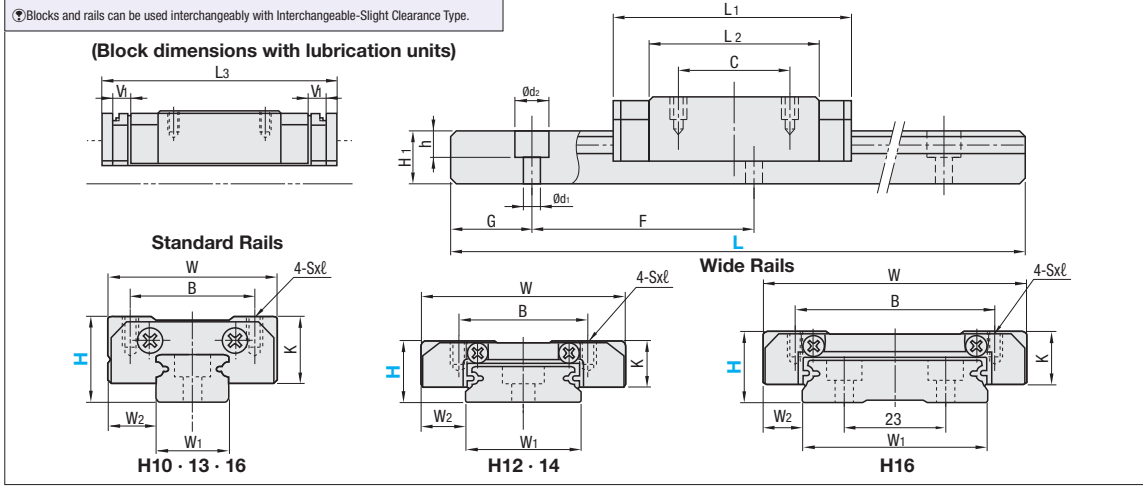

**Precautions for Use**

- Blocks are equipped with retainers (wire) to prevent balls from falling out. Refer to P501
- Straight grooves are provided on datum planes. Be sure to match the datum lines when using.
- Rails cannot be connected to be extended.
- Running parallelism is the value measured after the rail is mounted.

**Others**

The lubrication unit supplies fresh lubrication oil to the track surfaces continuously from porous plastic material containing a high proportion of lubricant, providing long term maintenance-free condition.

- For G dimensions of L Dimension Configurable Type, refer to P507

Part Number		Block Dimensions										Guide Rail Dimensions																				
Type	H	W	L1	B	C	Sxℓ	L2	L3	V1	K	H1	W1	W2	Counterbored Holes d1xd2xh	F	G																
(Standard Rail) Sets SAUS SAUPS SAUSL SAUPS	10	20	30	15	10	M3x3	20	36.4	3.2	7.8	5.5	9	5.5	3.5x6x4.5	20	7.5																
																	13	27	35.2	20	15	M3x3.5	21.8	42.2	3.5	10	7.5	12	7.5	3.5x6x4.5	25	10
(Wide Rail) Sets SAWS SAWPS SAWSL SAWPS	12	30	39.8	21	12	M3x3	27.6	46.8	3.5	8	7.5	18	6	3.5x6x4.5	30	10																
																	14	40	45	28	15	M3x4	31	53	4	10	8.5	24	8	4.5x8x4.5	40	15

kgf=Nx0.101972

H	Basic Load Rating		Allowable Static Moment		Mass		
	C (Dynamic) kN	Co (Static) kN	MA / MB N · m	Mc N · m	Blocks kg	Guide Rails kg/m	
Standard Rails	10	1.49	2.15	6.1	9.9	0.02	0.35
	13	2.83	3.50	11.0	21.0	0.04	0.65
	16	5.55	6.60	26.0	49.0	0.07	1.05
Wide Rails	12	3.00	4.50	17.0	36.0	0.04	0.95
	14	4.35	6.35	29.0	71.0	0.08	1.40
	16	7.60	10.40	59.0	207.0	0.15	2.75

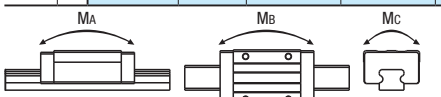
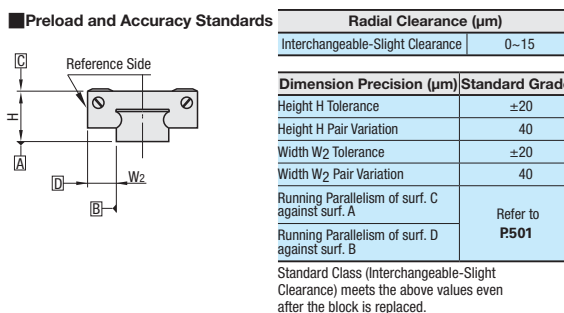

**Order Example**

Part Number - L  
SAUS10 - 155  
SAUL10 - 155  
SAU10

**Days to Ship**

8 Days (Selectable Type / Blocks only)  
10 Days (L Dimension Configurable Type SAUSL, SAUPS, SAWSL, SAWPS, SAULF, SAWLF)

Express A 5,00 EUR / piece P. 88  
Express Charge of 13,50 EUR for 3 or more identical pieces.

**Alterations**

Part Number - L - (LLC · RLC)  
SAUS10 - 155 - LLC  
10 Days

Alterations	Code	Spec.	Price Adder
Rail Ends Cut	Left End Cut LLC	Cuts rail ends. Ordering Code LLC	5,00
	Right End Cut RLC		5,00

Rail is cut with the product ID facing out (datum on other side).

**Price**

**Sets Volume Discount** (Round down to one Cent.) P. 87

Quantity	1-5	6 or 7	8 or 9	10-20
Discount Rate	€ Unit Price	5%	10%	18%

**Rails, Blocks Volume Discount** (Round down to one Cent.) P. 87

Quantity	1-5	6 or 7	8 or 9	10-20
Discount Rate	€ Unit Price	5%	10%	23%

**Standard Rails**

Part Number	Type	H	Selectable L	€ Unit Price		
				Sets	Rails	Blocks
SAUS	10		55			
			75			
			95			
			115			
			155			
SAUPS (With Lubrication Units)	10		195			
			275			
			120			
			170			
			220			
SAUL (Rails)	13		270			
			320			
			370			
			470			
			150			
SAU (Blocks)	13		230			
			310			
			430			
			550			
			670			
SAUP (With Lubrication Unit) Blocks	16		310			
			430			
			550			
			670			
			790			

Part Number	Type	H	L Specified (1mm Increment)	€ Unit Price		
				Sets	Rails	Blocks
SAUSL	10		56-74			
			76-94			
			96-114			
			116-154			
			156-194			
SAUPS (With Lubrication Units)	10		196-274			
			121-169			
			171-219			
			221-269			
			271-319			
SAULF (Rails)	13		321-369			
			371-469			
			151-229			
			231-309			
			431-549			
	16		551-669			

**Wide Rails**

Part Number	Type	H	Selectable L	€ Unit Price		
				Sets	Rails	Blocks
SAWS	12		80			
			110			
			140			
			170			
			200			
			260			
			290			
			380			
			110			
			150			
SAWPS (With Lubrication Units)	12		190			
			230			
			390			
			470			
			790			
SAWL (Rails)	14		150			
			190			
			230			
			310			
			390			
SAW (Blocks)	14		470			
			790			
			150			
			230			
			310			
SAWP (With Lubrication Unit) Blocks	16		430			
			550			
			670			
			790			
			990			

Part Number	Type	H	L Specified (1mm Increment)	€ Unit Price		
				Sets	Rails	Blocks
SAWSL	12		81-109			
			111-139			
			141-169			
			171-199			
			201-259			
			261-289			
			291-379			
			111-149			
			151-189			
			191-229			
SAWPS (With Lubrication Units)	12		231-309			
			311-389			
			391-469			
			471-789			
			151-229			
SAWLF (Rails)	14		231-309			
			311-429			
			431-549			
			551-669			
			671-989			