

# Loss-Proof Chains

CAD Data

## Loss-Proof Stainless Steel Chains

SCHSP



RoHS 10

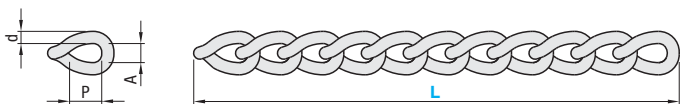

Material: 1.4301/X5CrNi18-10

Part Number	L 50mm Increment	P	A	d	Reference Applied Load	€ Unit Price
SCHSP	100~500	5.5	2.5	1.6	9kg	
	550~1000					

The reference applied load is only a guideline.

## Loss-Proof Ball Chains

BALLC



RoHS 10

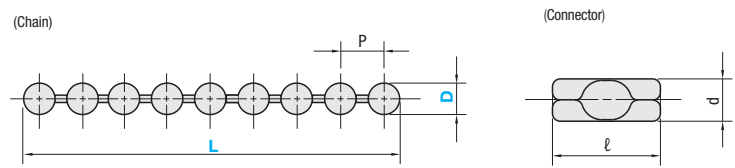

Material: 1.4301/X5CrNi18-10

Part Number		L 50mm Increment	P	Reference Applied Load	Accessory (Connector)		€ Unit Price
Type	D				d	l	
BALLC	2.3	100~500	3.3	4kg	3.0	8	
		550~1000					
	3.2	100~500	4.4	6kg	4.3	11	
		550~1000					

\* Depending on the number of links, the actual L dimension may be slightly longer than the specified dimension. (Connecting Parts: A connector is attached.)

The reference applied load is only a guideline. Dimensions of chains and connecting parts are for reference only.

## Chains

CHSP

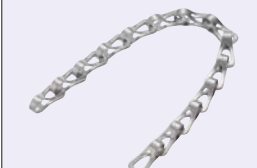

RoHS 10

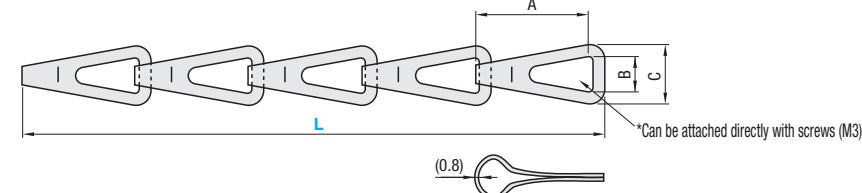

Material: 1.4301/X5CrNi18-10

Part Number	L 50mm Increment	A	B	C	Plate Thickness	Reference Applied Load	€ Unit Price
Type	No.						
CHSP	4	100~500	15.5	4.2	8	0.8	70kg
		550~1000					

\* Depending on the number of links, the actual L dimension may be slightly longer than the specified dimension. (Please refer to <http://jp.misumi-ec.com/mech/>.)

Connecting parts are not included. UH: ERL IN EN/CS/de

The reference applied load is only a guideline.

Order Example	Part Number	-	L
	SCHSP	-	600
	BALLC2.3	-	150
	CHSP4	-	100

Days to Ship	8 Days	Express A	2,00 EUR / piece	P88
A Express Charge of 5,40 EUR for 3 or more identical pieces.				

Price	Volume Discount (Round down to one Cent.) P87
Quantity	1~19 20~29 30~49 50~99
Discount Rate	€ Unit Price 5% 10% 18%
For orders larger than indicated quantity, please request a quotation.	

# Loss-Proof Wires / Connecting Parts, Mounting Brackets

CAD Data

## Loss-Proof Wires

LPWW



A Shape

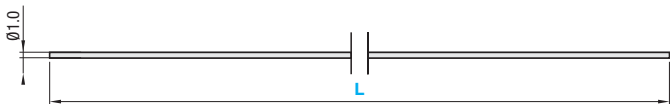

B Shape

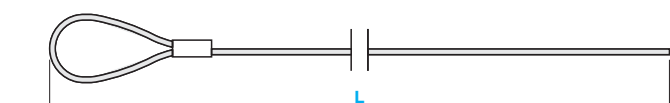

C Shape

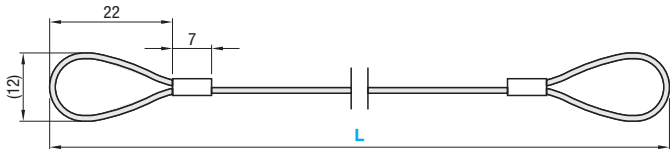

Dimension in ( ) is for reference only.

Material: 1.4301/X5CrNi18-10

Part Number		L 50mm Increment	Reference Applied Load	€ Unit Price		
Type	Shape			A	B	C
LPWW	A B C	100~500	9kg			
		550~1000				

The reference applied load is only a guideline.

Order Example	Part Number	-	L
	LPWW	-	850

Days to Ship	8 Days
--------------	--------

Price	Volume Discount (Round down to one Cent.) P87
Quantity	1~19 20~29 30~49 50~99
Discount Rate	€ Unit Price 5% 10% 18%
For orders larger than indicated quantity, please request a quotation.	

## Metal Joints

SKC

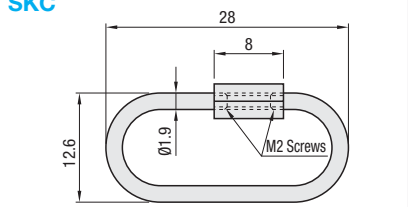

Material: 1.4301/X5CrNi18-10

## Brackets

TKC

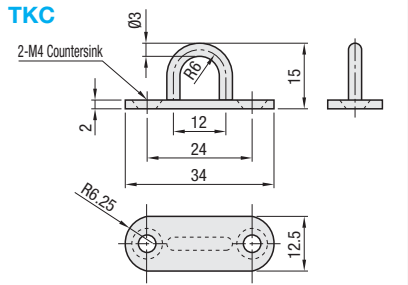

Material: 1.4301/X5CrNi18-10 Accessory: M4-5 Flat Head Screw 2pcs (1.4301/X5CrNi18-10)

## Connecting Parts UH: ERL IN EN/CS/de

### Double Rings

RWS

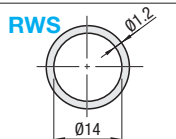

Material: 1.4401/X5CrNiMo17-12-2

### Double Rings

Part Number	Reference Applied Load	€ Unit Price	Volume Discount			
Type	No.		Qty. 1	2~3	4~19	20~99
RWS	14	1kg				

The reference applied load is only a guideline.

Order Example	Part Number	-	L
	RWS14	-	1kg

Days to Ship	8 Days	Express A	2,00 EUR / piece	P88
A Express Charge of 5,40 EUR for 3 or more identical pieces.				