



Blind Joint Components

-Single Joint Kits-

Alterations necessary to use this component

Wrench Hole
→P649

D type hole alteration
→P654

CAD Data How to use P636

■Features: D holes added on extrusions do not penetrate to the flat face. Blind Joints with very good appearance.

Single Joint Kits -Standard Type-

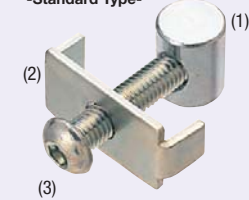

Single Joint Kits -Narrow Type-



(Ref.) Corner section when using this joint

Type	Material	Surface Treatment
Nuts	1.0038/S235JR	Trivalent Chromate
Stainless Steel Nut	1.4401- equivalent, 1.4301/X5CrNi18-10	-
Plate	1.0330/DC01	Trivalent Chromate
Stainless Steel Plate	1.4301/X5CrNi18-10	-
Narrow Plate	-	-
Button Head Cap Screw	1.7220/34CrMo4	Trivalent Chromate
Button Head Cap Screw Stainless Steel	1.4301/X5CrNi18-10	-

Single Joint Kits -Standard Type-

Use it when edges of two extrusions are connected perpendicularly, after a hole is drilled in each extrusion. Refer to P636

HSJ (Steel Type)
HSJS (Stainless Steel)

(1)Joint Nut

Nut (1.0038/S235JR)
Stainless Steel Nut (1.4301/X5CrNi18-10 / 1.4401- Equivalent, Sintering)

(2)Joint Plate

Plate (1.0330/DC01)
Stainless Steel Plate (1.4301/X5CrNi18-10)

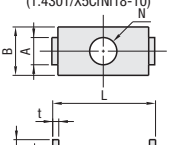
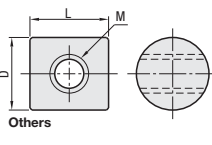
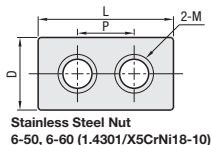

⚠For only Stainless Steel Nut 6-50 and 6-60, the material is 1.4301/X5CrNi18-10.

Single Joint Kits -Narrow Type-

Shape of Narrow Type has altered so that its joint section does not collide with the panel when the panel is inserted into the frame slot. Refer to P680

HSJNS (Stainless Steel)

(1)Joint Nut

Stainless Steel Nut (1.4401/X5CrNiMo17-12-2, Sintering)

(2)Narrow Type Joint Plate

Narrow Plate (1.4301/X5CrNi18-10)

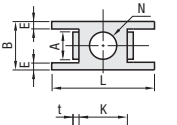
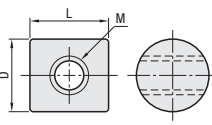
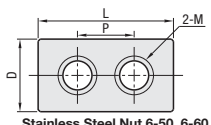

Single Joint Kits -Standard Type / Narrow Type-

Refer to the next page for the application to each extrusion.

Type	Part Number		Applicable Extrusions (Type)	(1) Joint Nut (1 pc.)		(2) Joint Plates		(3) Hexagon Socket Button Head Cap Screw		Steel Type		Stainless Steel Type	
	Type	No.		1.0038/S235JR	1.4301/X5CrNi18-10 / 1.4401- equivalent	1.0330/DC01	Qty.	1.7220/34CrMo4	Qty.	€ Unit Price	Volume Discount Rate	€ Unit Price	Volume Discount Rate
Standard	HSJ	6	Refer to Right Page	Nut 6	Stainless Steel Nut 6	Plate 6	1	Button Head Cap Screw M6-25	1	1-99 pcs.	100~	1-99 pcs.	100~
	HSJS	6-50		-	Stainless Steel Nut 6-50	-	-	-	-	-	-	-	-
	HSJS	6-60		-	Stainless Steel Nut 6-60	-	-	-	-	-	-	-	-
	HSJS	8		Nut 8	Stainless Steel Nut 8	Plate 8	1	Button Head Cap Screw M8-35	1	-	-	-	-
Narrow	HSJNS	6	Refer to Right Page	-	Stainless Steel Nut 6	-	-	-	-	-	-	-	-
	HSJNS	6-50		-	Stainless Steel Nut 6-50	-	-	-	-	-	-	-	-
	HSJNS	6-60		-	Stainless Steel Nut 6-60	-	-	-	-	-	-	-	-
	HSJNS	8		-	Stainless Steel Nut 8	-	-	-	-	-	-	-	-

* Not applicable to 45 Square Light Type Series (HFSL8-45).

(1) Dimension of Joint Nut

Type	Size	M	D	P	L
Nuts	6	6	11	-	12
	6-50	6	11	20	32
	6-60	6	11	30	42
	8	8	13	-	15
Narrow Plate	8-45	8	15	-	19

(2) Dimension of Joint Plate

Type	Size	N	A	1.0330/DC01				1.4301/X5CrNi18-10 / 1.4401- equivalent			
				B	L	T	t	B	E	L	T
Plate	6	6.5	8	14	29	7.6	1.6	14	-	29	7.5
	6-50	6.5	8	14	19	7.6	1.6	14	-	19	7.5
	8	8.5	10	18	38	12	2.0	18	-	38	12
	8-45	8.5	10	18	38	12	2.0	18	-	38	12
Narrow Plate	6	6.5	5	-	-	-	-	15	3	25	7.5
	6-50	6.5	5	-	-	-	-	15	3	19	7.5
	8	8.5	6	-	-	-	-	18	3.5	34	12
	8-45	8.5	6	-	-	-	-	18	3.5	39	12

Order Example
Part Number
HSJ8

Days to Ship
6 Days
P:87



Example

•When mounting rectangular extrusions such as HFS6-3060, 8-4080 or 8-4590, refer to the below example.

Ex. (1)

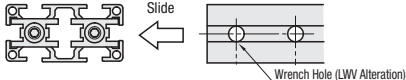

<Completed>

Ex. (2)

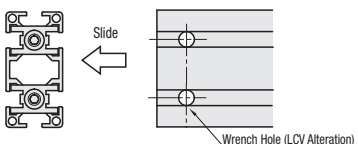

<Completed>



Example

Single Joint Connection Method (Connect the extrusions at the corners.)

Step	Front View	Side View	Sketch Drawing
1			Drills D type hole in the frame. Insert joint nut (1) in the extrusion where hole D is drilled.
2			Put the button bolt (3) through the joint plate (2), lightly tighten it temporarily.
3			Pass joint plate (2) through slot in the extrusion (B) where the wrench hole was drilled and slide it to bottom of (A).
4			Tighten the button bolt (3) with a hexagonal wrench through the wrench hole.

Connection Method by Part Number(30 Square as an Example)

(A) HFS6-3030-1000-LDH

Length (optional)
Adds a D hole horizontally on the left side of the extrusion.

HSJNS6 (Single Joint / Narrow Type)

(1)Stainless Steel Nut 6

(2)Narrow Plate 6

(3)Button Head Cap Screw Stainless Steel M6-25

(B) HFS6-3030-800-LCV

Length (optional)
Adds a wrench hole vertically on the left side of the extrusion.

Method of Shortening the Extrusion to Compensate for the Thickness of Extrusion End Cap (Single Joint / Narrow Type)

For normal specification, the extrusion end cap adds its thickness to the length of a frame when it is mounted. With optional specification of the extrusion and change of the single joint, extrusion end cap and extrusion can be flat. Beforehand, please specify the extrusion length 3mm shorter (one side) to compensate for the thickness of the extrusion end cap. (The length is shortened by 6mm when wrench holes are located at both ends.)

•To specify options for extrusions, see P651

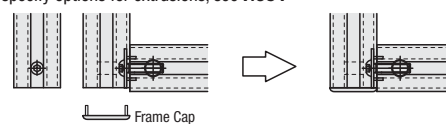

In this case, use HSJNS instead of HSJ or HSJS.
(As the L dimension of HSJ is long, it fits the extrusion end cap.)

Extrusions Applicable to Single Joint (Not applicable to extrusions not listed in the table.)

Features	Extrusions			Features	Extrusions			Features	Extrusions		
	Type	No.	Applicable single joint		Type	No.	Applicable single joint		Type	No.	Applicable single joint
Four-Side Slots	HFS6 GFS6 EFS6 CAF6 HFSY6	3030	HSJ6 / HSJS6 / HSJNS6	Four-Side Slots	HFS8 GFS8 EFS8 CAF8 HFSY8	4040	HSJ8 / HSJS8 / HSJNS8	Four-Side Slots	HFS8 GFS8 EFS8	4545	HSJ8-45 / HSJS8-45 / HSJNS8-45
		3060	HSJ6 / HSJS6 / HSJNS6			4080	HSJ8 / HSJS8 / HSJNS8			4590	HSJ8-45 / HSJS8-45 / HSJNS8-45
		3090	HSJ6 / HSJS6 / HSJNS6			40120	HSJ8 / HSJS8 / HSJNS8			45180	HSJ8-45 / HSJS8-45 / HSJNS8-45
		5050	HSJ6 / HSJS6 / HSJNS6			40160	HSJ8 / HSJS8 / HSJNS8			-	-
Three-Side Slots One Flat	HFSF6 EFSF6	3030	HSJ6 / HSJS6 / HSJNS6	Three-Side Slots One Flat	HFSF8 GFSF8 EFSF8	4040	HSJ8 / HSJS8 / HSJNS8	Three-Side Slots One Flat	HFSF8 GFSF8 EFSF8	4545	HSJ8-45 / HSJS8-45 / HSJNS8-45
		3060	HSJ6 / HSJS6 / HSJNS6			-	-			-	-
		6060	HSJ6 / HSJS6 / HSJNS6			-	-			-	-
		60120	HSJ6 / HSJS6 / HSJNS6			-	-			-	-
Two-Side Slots Two Flats	HFSF8 EFSF8	3030	HSJ6 / HSJS6 / HSJNS6	Two-Side Slots Two Flats	HFSF8 GFSF8 EFSF8	4040	HSJ8 / HSJS8 / HSJNS8	Two-Side Slots Two Flats	HFSF8 GFSF8 EFSF8	4545	HSJ8-45 / HSJS8-45 / HSJNS8-45
		3060	HSJ6 / HSJS6 / HSJNS6			-	-			-	-
		6060	HSJ6 / HSJS6 / HSJNS6			-	-			-	-
		60120	HSJ6 / HSJS6 / HSJNS6			-	-			-	-
Two Slots on Opposite Sides	HFSH6 EFSH6	3030	HSJ6 / HSJS6 / HSJNS6	Two Slots on Opposite Sides	HFSH8 GFSH8 EFSH8	4040	HSJ8 / HSJS8 / HSJNS8	Two Slots on Opposite Sides	HFSH8 GFSH8 EFSH8	4545	HSJ8-45 / HSJS8-45 / HSJNS8-45
		3060	HSJ6 / HSJS6 / HSJNS6			-	-			-	-
		6060	HSJ6 / HSJS6 / HSJNS6			-	-			-	-
		60120	HSJ6 / HSJS6 / HSJNS6			-	-			-	-
One-Side Slot Three Flats	HFSF6 EFSF6	3030	HSJ6 / HSJS6 / HSJNS6	One-Side Slot Three Flats	HFSF8 GFSF8 EFSF8	4040	HSJ8 / HSJS8 / HSJNS8	One-Side Slot Three Flats	HFSF8 GFSF8 EFSF8	4545	HSJ8-45 / HSJS8-45 / HSJNS8-45
		3060	HSJ6 / HSJS6 / HSJNS6			-	-			-	-
		6060	HSJ6 / HSJS6 / HSJNS6			-	-			-	-
		60120	HSJ6 / HSJS6 / HSJNS6			-	-			-	-
Light Type	HFSL6	3030	HSJ6 / HSJS6 / HSJNS6	Light Type	HFSL8	4040	HSJ8 / HSJS8 / HSJNS8	Light Type	HFSL8	4545	HSJ8-45 / HSJS8-45 / HSJNS8-45
		3060	HSJ6 / HSJS6 / HSJNS6			4080	HSJ8 / HSJS8 / HSJNS8			4590	HSJ8-45 / HSJS8-45 / HSJNS8-45
		3090	HSJ6 / HSJS6 / HSJNS6			40120	HSJ8 / HSJS8 / HSJNS8			45180	HSJ8-45 / HSJS8-45 / HSJNS8-45
		5050	HSJ6 / HSJS6 / HSJNS6			40160	HSJ8 / HSJS8 / HSJNS8			-	-
Black Anodize	HFSB6 EFSB6	3030	HSJ6 / HSJS6 / HSJNS6	Black Anodize	HFSB8 EFSB8	4040	HSJ8 / HSJS8 / HSJNS8	Black Anodize	HFSB8 EFSB8	4545	HSJ8-45 / HSJS8-45 / HSJNS8-45
		3060	HSJ6 / HSJS6 / HSJNS6			4080	HSJ8 / HSJS8 / HSJNS8			4590	HSJ8-45 / HSJS8-45 / HSJNS8-45
		3090	HSJ6 / HSJS6 / HSJNS6			40120	HSJ8 / HSJS8 / HSJNS8			45180	HSJ8-45 / HSJS8-45 / HSJNS8-45
		5050	HSJ6 / HSJS6 / HSJNS6			40160	HSJ8 / HSJS8 / HSJNS8			-	-