



Pushers for Cylinder with Guide · MC Nylon · Polyacetal Pushers

-Metal Plate Baked Type · MC Nylon Type-

CAD Data

Features: Upper: Pushers which fit mounting diameters (pitch) for cylinder with guide. Bottom : MC nylon used pushers. For maintenance, resin for replacement is provided.

Pushers for Cylinder with Guide

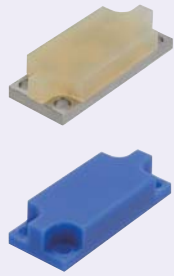

Type	Material	Hardness	Plate
GPSHA	Ether Polyurethane	Shore A90	1.4301/ X5CrNi18-10
GPSHS	Ester Polyurethane	Shore A70	
GPSHM	MC Nylon		

For urethane rubber properties, refer to P.358
For MC nylon properties, refer to P.858

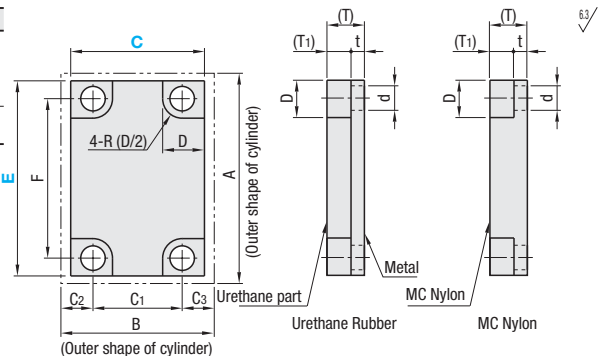
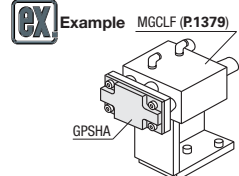

Type	Plate Mounting Part External Dimensions			Cylinder External Dimensions		Reference Tube Inner Diameter	Mounting Hole Pitch				(T)	(T1)	t	Mounting Hole Information		€ Unit Price		
	C	E	A	B	F		C1	C2	C3	D				d	GPSHA	GPSHS	GPSHM	
GPSHA	22	56	58	26	12	48	14	6	6	12	7	4.9	8	4.5				
GPSHS	25	62	64	30	16	52	16	7	7	13	8		9.5	5.5				
GPSHM	38	86	96	42	25	70	26	8	8	14	9		13.5	6.6				
	48	112	116	51	32	96	30	11	10	16	11		17	8.5				

Urethane rubber is baked on a metal plate. Although urethane rubber could be discolored over time, it does not affect its property.
For MC nylon, use a float washer (P.232) to protect the resin from being damaged.

MC Nylon Polyacetal Pushers



Type	Shape		Material
	Flat	Round	
MC Nylon	Female Thread	PSHMC RSHMC	1.4301/ X5CrNi18-10 Nylon Core Rod: 1.4301
	Male Thread	PSHMMC RSHMMC	
Polyacetal	Replacement Resin	MCKK MCRKK	MC Nylon
	Female Thread	PSHPA RSHPA	
	Male Thread	PSHMPA RSHMPA	
	Replacement Resin	PAKK PARKK	

For MC nylon properties, refer to P.858
For polyacetal properties, refer to P.858
ℓ2 (resin across flats) for D6 and D8 is as follows.

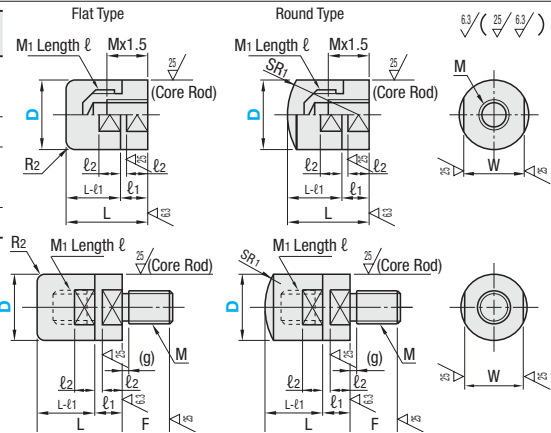
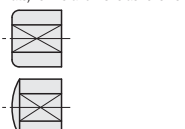

Female Thread Tap depth for resin for replacement is ℓ. Positions of the flats on resin and core rod may not coincide.

Part Number	Type	D	L	MxPitch	M1xPitch	ℓ	SR1	R2	ℓ1	ℓ2	W	€ Unit Price							
												MC Nylon				Polyacetal			
												Set	Replacement Resin	Set	Replacement Resin				
Set Flat Replacement Resin Flat	PSHMC RSHMC MCKK MCRKK PSHPA RSHPA PAKK PARKK	8	12	M3x0.5	M5x0.8	4.5	8												
		10	15	M4x0.7	M6x1.0	7	10	1	5	4	8								
		12	16	M5x0.8	M8x1.25	8	12												
		15	20	M6x1.0	M10x1.5	10	16	2	6	5	14								
		20	25	M8x1.25	M12x1.75	12	20		8	6	17								
		25	30	M10x1.5	M16x2.0	14	25	3	10	8	22								
		30	35	M12x1.75	M16x2.0	18	30												

Male Thread

Part Number	Type	D	L	MxPitch (Coarse Thread)	M1xPitch (Coarse Thread)	ℓ	SR1	R2	F	(g)	ℓ1	ℓ2	W	€ Unit Price							
														MC Nylon				Polyacetal			
														Set	Replacement Resin	Set	Replacement Resin				
Set Flat Replacement Resin Flat	PSHMMC MCKK PSHMPA PAKK RSHMMC MCRKK RSHMPA PARKK	6	10	M3x0.5	M3x0.5	3	6				1.5		5								
		8	12	M4x0.7	M5x0.8	4.5	8	1	6					7							
		10	15	M5x0.8	M6x1.0	7	10							8							
		12	16	M6x1.0	M8x1.25	8	12							10							
		15	20	M8x1.25	M10x1.5	10	16	2						14							
		20	25	M10x1.5	M12x1.75	12	20	3	14					17							

Order Example: Part Number GPSHA2562, GPSHM48112, PSHMC20, MCRKK12. Days to Ship: 6 Days. Price: Volume Discount (Round down to one Cent.) P.87. Discount Rate: 5%.



Low Hardness Urethane Pushers · Fluororubber Pushers

-Female Thread Type - Male Thread Type-

CAD Data

Features: Low hardness urethane pushers: Shore A30 used urethane pushers which give small impact to work. Fluoro-Rubber Pushers: Pushers which is made of fluorine with excellent chemical resistance.

Female Thread Type



Type	Material	Hardness	Color	Material	
					Flat
PSHLH	RSHLH	Ester Polyurethane	Shore A30	Natural color	1.4301/X5CrNi18-10
PSHPT	RSHTPT	Fluorine Rubber (FPM)	Shore A80	Black	

For properties of urethane rubber and fluoro-rubber, refer to P.358

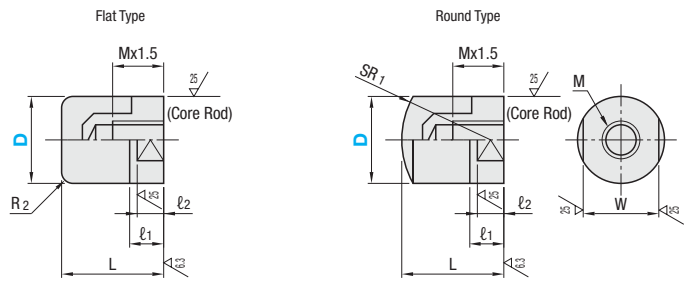

Part Number	Type	D	L	MxPitch	SR1	R2	ℓ1	ℓ2	W	€ Unit Price			
										PSHLH	RSHLH	PSHPT	RSHTPT
Flat	Round	8	12	M3x0.5	8	1	5	4	7				
		10	15	M4x0.7	10				8				
		12	16	M5x0.8	12	2			10				
		16	20	M6x1.0	16				14				
		20	25	M8x1.25	20	3	8	6	17				

Urethane rubber and fluororubber are thermally bonded to a core rod. Although urethane rubber could be discolored over time, it does not affect its property.

Male Thread Stud Type



Type	Material	Hardness	Color	Material	
					Flat
PSHMLH	RSHMLH	Ester Polyurethane	Shore A30	Natural color	1.4301/X5CrNi18-10
PSHMPT	RSHMPT	Fluorine Rubber (FPM)	Shore A80	Black	

For properties of urethane rubber and fluoro-rubber, refer to P.358

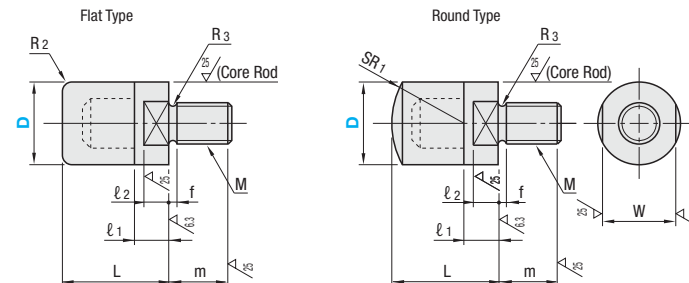

Part Number	Type	D	L	MxPitch (Coarse Thread)	SR1	R2	m	ℓ1	ℓ2	f	R3 Max.	W	€ Unit Price			
													PSHMLH	RSHMLH	PSHMPT	RSHMPT
Flat	Round	6	10	M3x0.5	6		4.5				0.3	5				
		8	12	M4x0.7	8	1	6	5	4	1	0.5	7				
		10	15	M5x0.8	10							8				
		12	16	M6x1.0	12	2	10				1.5	0.75	10			
		16	20	M8x1.25	16		12	6	5	2	1	14				

Urethane rubber and fluororubber are thermally bonded to a core rod. Although urethane rubber could be discolored over time, it does not affect its property.

Order Example: Part Number PSHLH8. Days to Ship: 6 Days. Price: Volume Discount (Round down to one Cent.) P.87. Discount Rate: 5%.