

P.C. MOUNTING

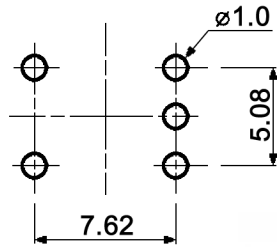

x	Switch function
D	on - on
E	on - off - on
F	mom - on
G	mom - off - mom
H	mom - off - on

Lever position:  
 For code F and H: "mom" is on the right side when looking at the marking side.  
 The closed contacts are opposite to the lever position.

Specifications:

- Contact rating: max.: 0.4VA, 48V AC/DC / max. 50mA  
min.: 1µA, 20mV AC/DC
- Contact resistance: 50mOhm max.
- Insulation resistance: 500MOhm min. at 250V DC
- Dielectric strength: 50V, 50Hz for duration of 1 minute
- Operating temperature: -20°C to +85°C
- Mechanical life: min. 60 000 cycles
- Soldering conditions: auto-soldering: max.: 260 +/-5°C, 5 +/-1.0sec.
- Mounting: on pc-board
- Contacts: phosphor bronze gold plated over nickel barrier
- Terminals: PC terminals, crimped
- Material: Case: PBT, meets UL94V-0, washable  
Metal parts: nickel plated brass
- UL file number: E140532



Tolerances:	Date	Name
	08/09	dr
Modifications	Date	Name

ATE 1 x-RA

knitter-switch

20 25 54

Page

1/1