

## Separate units: Blocks

IP 20  
To be combined with a 1, 3 or 5 position clip (p. 65)

 Characteristics (p. 94)  
Cross reference list (p. 311)

### ▶ LED BLOCKS (CONTINUED)

#### FOR PCB (PIN STYLE)

Cat. No.



33PAWL

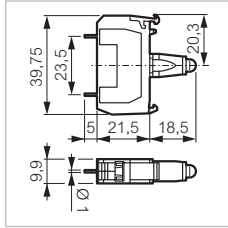

LED



#### 24 V

- White
- Red
- Green
- Blue
- Yellow

**33PAWL**  
**33PARL**  
**33PAGL**  
**33PABL**  
**33PAYL**

#### FOR CONTROL STATIONS (SCREW TERMINALS)



33SAGH

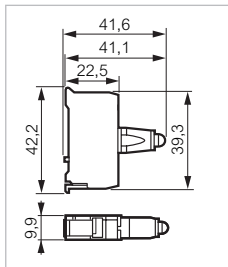

For un-equipped control stations (p. 86)  
Base mounted

LED



#### 24 V

- White
- Red
- Green
- Blue
- Yellow

**33SAWL**  
**33SARL**  
**33SAGL**  
**33SABL**  
**33SAYL**

#### 130 V

- White
- Red
- Green
- Blue
- Yellow

**33SAWM**  
**33SARM**  
**33SAGM**  
**33SABM**  
**33SAYM**

#### 230 V

- White
- Red
- Green
- Blue
- Yellow

**33SAWH**  
**33SARH**  
**33SAGH**  
**33SABH**  
**33SAYH**